



Presentation on Bus Storage Facilities Project

April 11, 2011

Transbay Transit Center

TJPA





Agenda

1. Project Update
2. Schematic Layout
3. Soundwalls
4. Landscaping
5. Lighting
6. Bus Emissions
7. Schedule
8. Questions & Answers



Project Update

- Concept Design
 - Completed topographic, underground surveys
 - Analyzed excavation requirements
 - Developed schematic layout
- Caltrans Coordination
 - WASSP Seismic Analysis: meeting with Caltrans Structures Division; developing baseline and final analysis
 - Project Study Report/Project Report (PSR/PR): Formal engineering report detailing ramp geometry, engineering design, advance planning studies (APS), approvals, ROW details, etc.



Transbay Transit Center

Schematic Layout

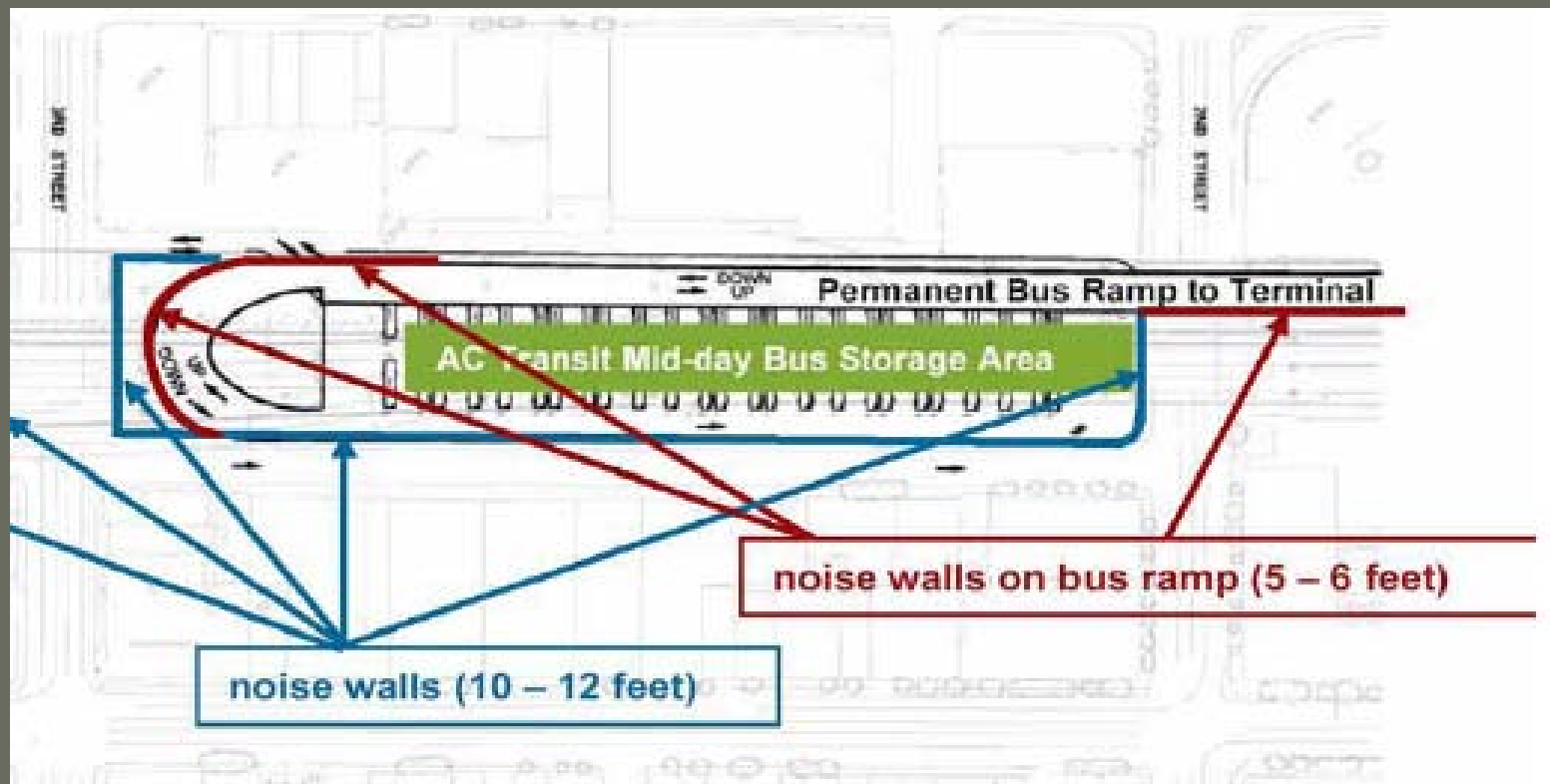

FEIS/FEIR Figure 2.2-6



Transbay Transit Center

Schematic Layout

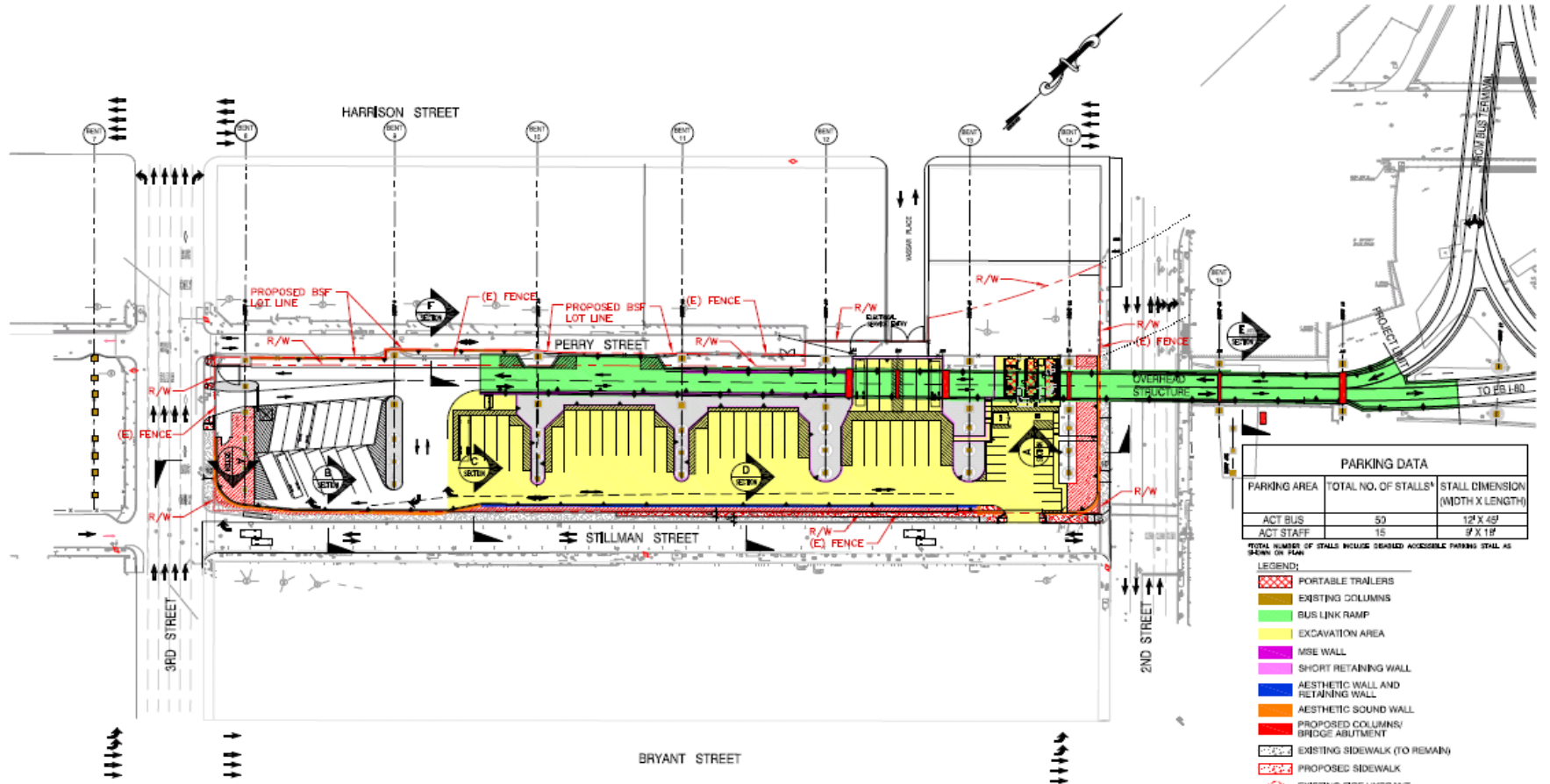

PRELIMINARY ENGINEERING
TRANSBAY BUS STORAGE
(AC TRANSIT SITE)



SCALE: 1" = 40'-0"

REVISION LAYOUT
DATE: 03/28/2011





Transbay Transit Center

Soundwalls

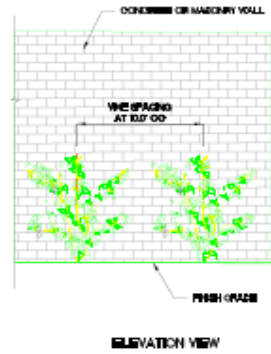
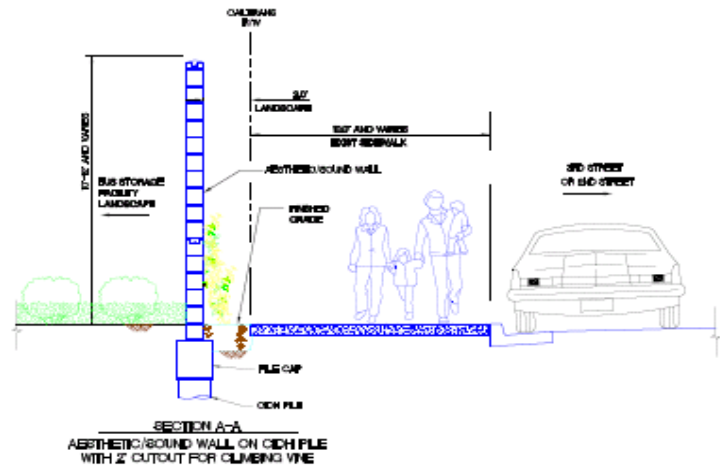

PRELIMINARY ENGINEERING
TRANSBAY BUS STORAGE
(AC TRANSIT SITE)



DATE: 08/11/11



Wall Section A-A



Transbay Transit Center

Soundwalls

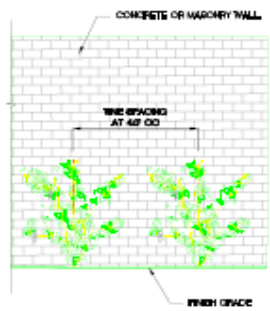
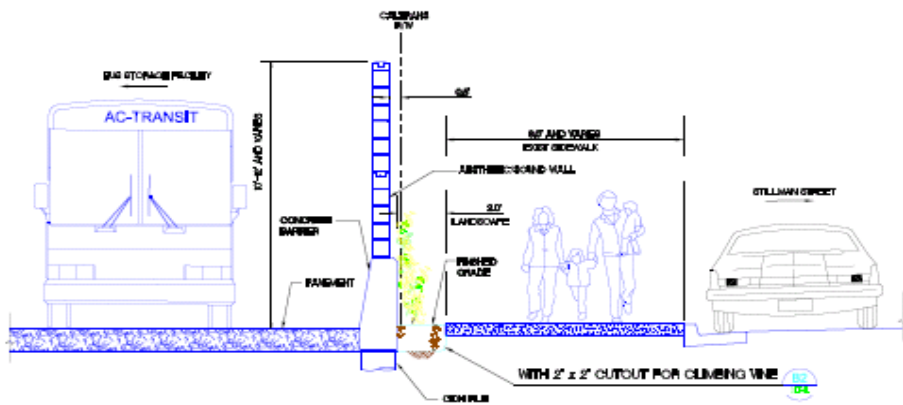

ELEVATION VIEW

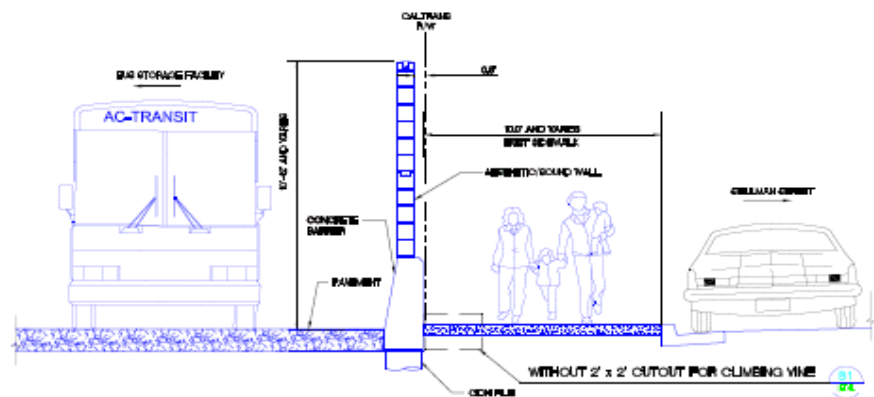

SECTION B-B
AESTHETIC SOUND WALL
ON BARRIER ON CON PILE

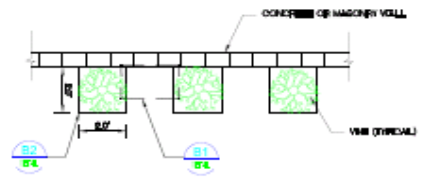

PLAN VIEW

PRELIMINARY ENGINEERING
TRANSBAY BUS STORAGE
(AC TRANSIT SITE)



Wall Section B-B

Soundwalls

Transbay Transit Center

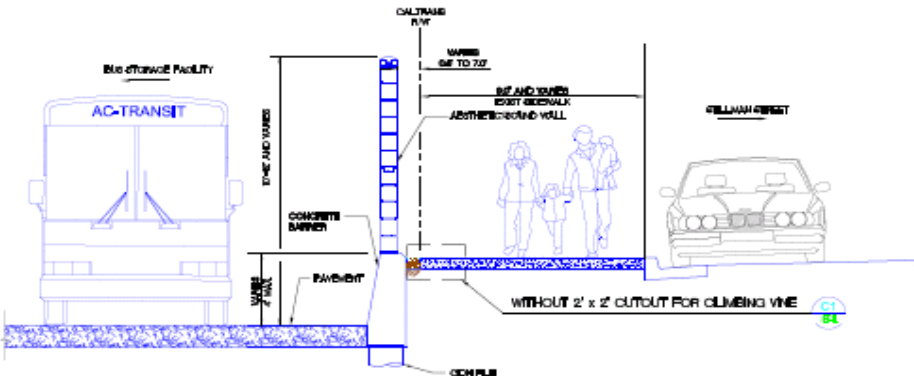
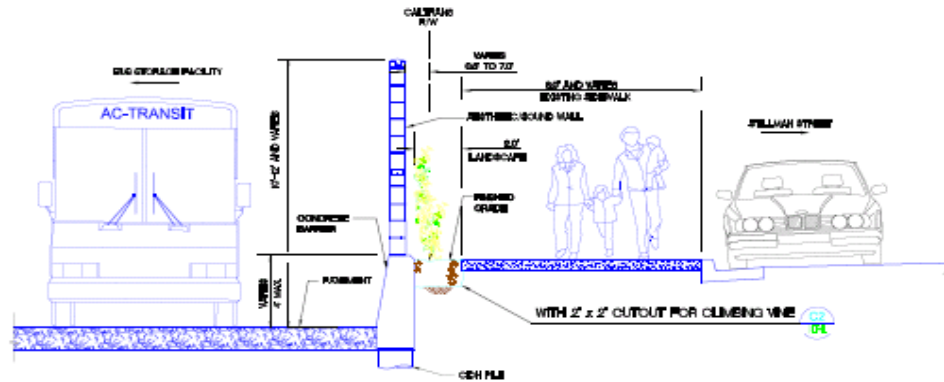

SECTION C-C
AESTHETIC/SOUND WALL
WITH BARRIER ON CCM PILE
ACTING AS RETAINING WALL

PRELIMINARY ENGINEERING
TRANSBAY BUS STORAGE
(AC TRANSIT SITE)

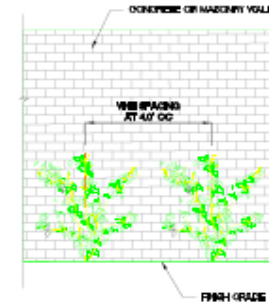

ELEVATION VIEW

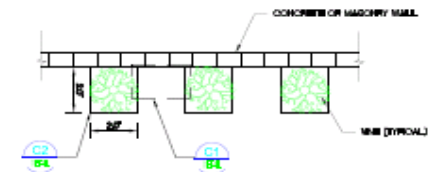

PLAN VIEW

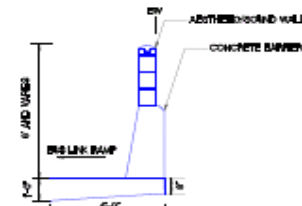

SECTION E-E
AESTHETIC/SOUND WALL
ON BRIDGE



Wall Section C-C



Transbay Transit Center

Soundwalls

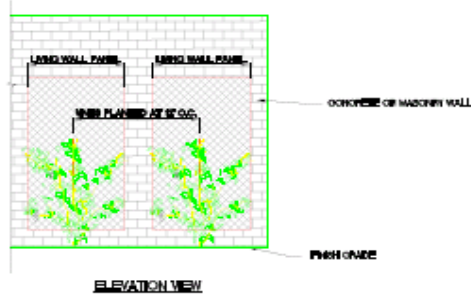
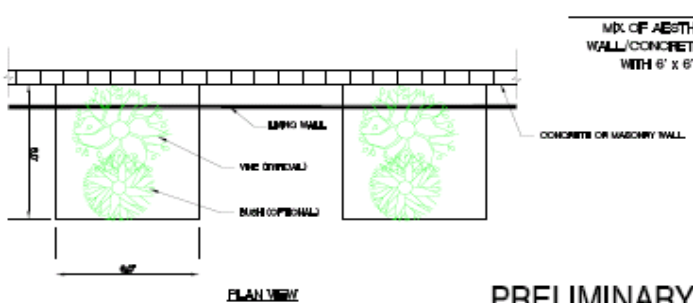
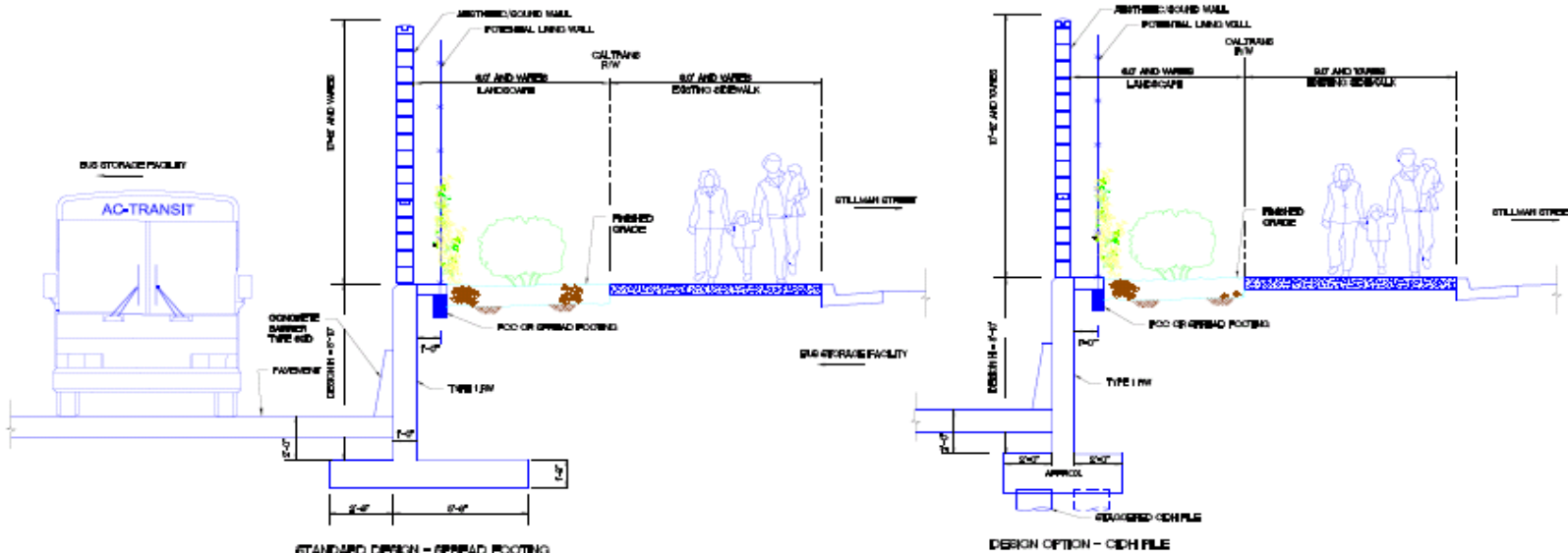

SECTION D-D
MIX OF AESTHETIC SOUND WALL ON RETAINING WALL/CONCRETE BARRIER ON SPREAD FOOTING WITH 6" x 6" CUTOUT FOR CLIMBING VINE

PRELIMINARY ENGINEERING
TRANSBAY BUS STORAGE
(AC TRANSIT SITE)



DATE: 08/11
SHEET: 0011



Wall Section D-D



Transbay Transit Center

Landscaping





Transbay Transit Center

Landscaping



Clematis lasiantha Pipestem Clematis



Macfadyena unguis-cati Cat's Claw



Wall Mounted Trellis with Vines Examples





Transbay Transit Center

Landscaping

Plant images:

Vines:



Gelsemium sempervirens

Carolina Jessamine



Polygonum aubertii

Silver Lace Vine



Cissus Antarctica

Kangaroo Treebine



Landscaping

- Arborist report commissioned to assess limits of excavation at Stillman St. trees
- Excavation of approximately 6' will impact rootballs of existing trees
- Arborist documented many trees were in poor condition and recommended replacement
- Propose removal of trees and replacement with more appropriate landscaping



Transbay Transit Center

Landscaping

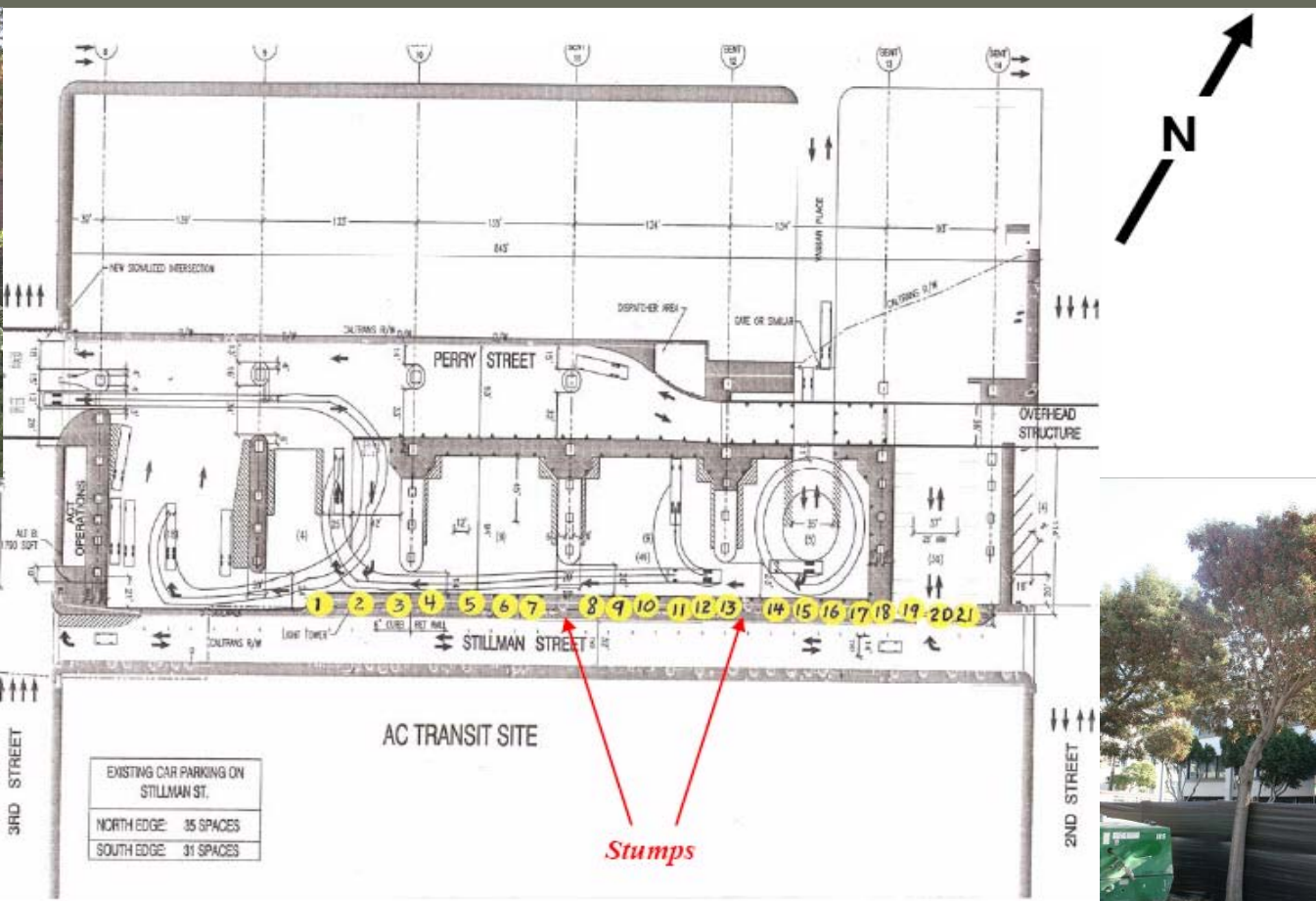

Stillman St. Trees



Lighting



Existing



Proposed

Third St. @ Perry St.



Lighting

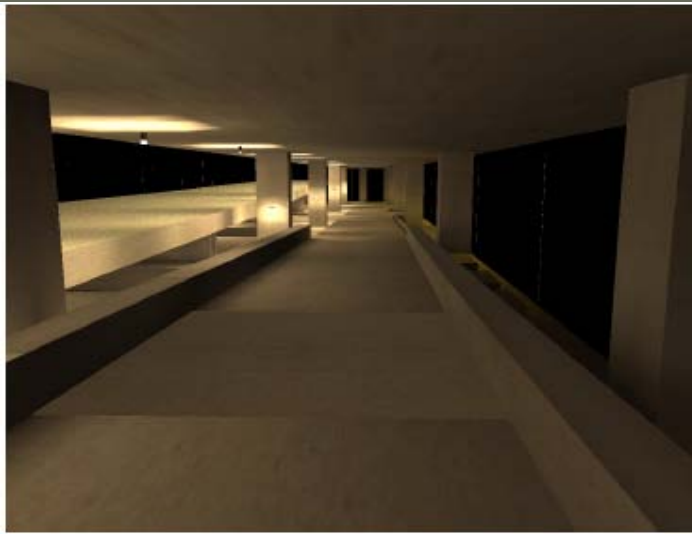

Existing



Proposed

Bus Link Ramp



Lighting

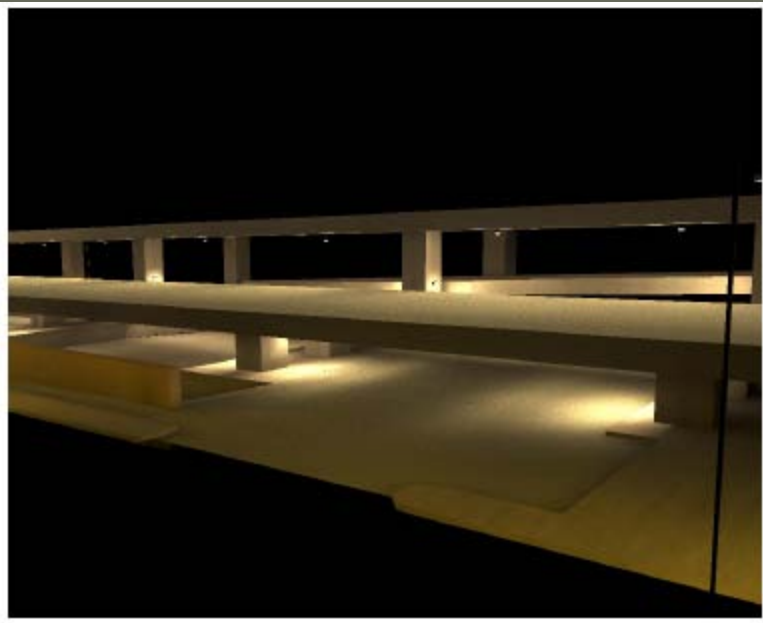

Existing



Proposed

Interior View @ Bents 13 & 14



Bus Emissions

Total PM Emissions AC Transit Urban Bus Fleet

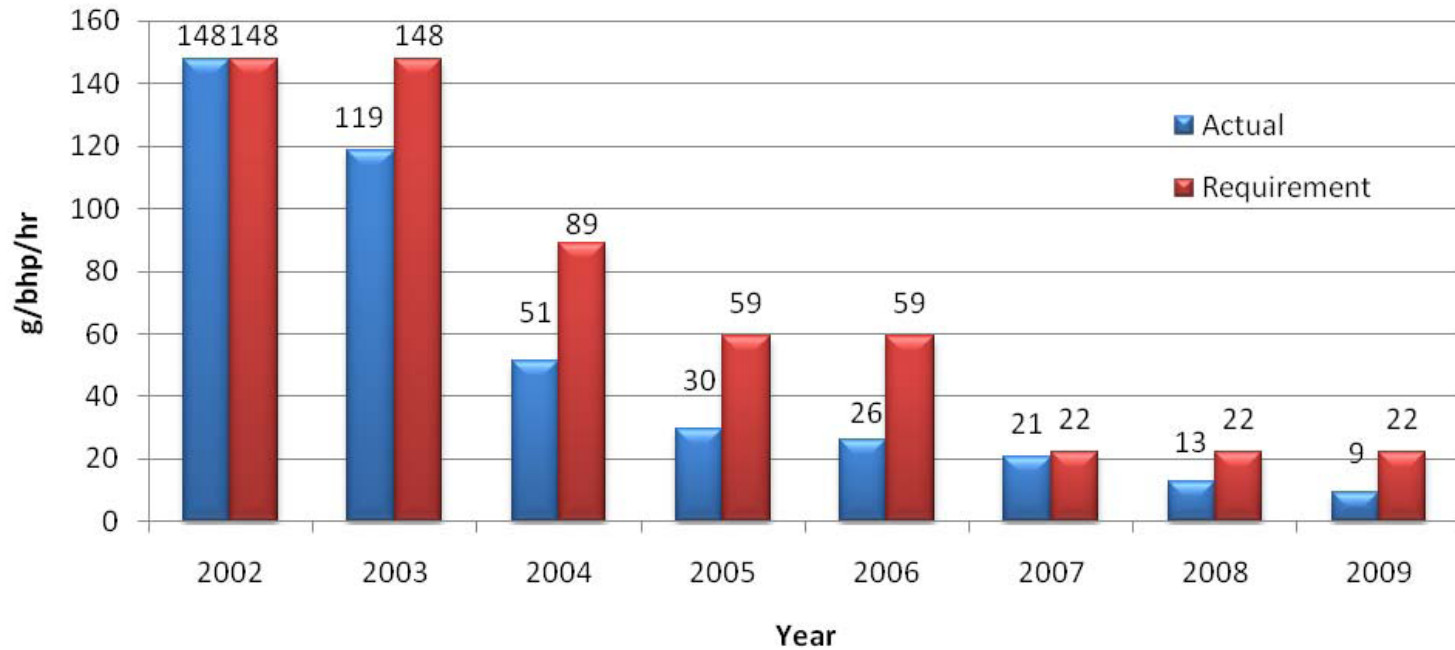



Bus Emissions

- CARB has established (5) minute idle limit for buses
- AC Transit enforces (3) minute idle limit
- AC Transit transbay buses outfitted with diesel traps
- No AC Transit idling/emissions complaints at Temporary Terminal



Schedule

Next Steps :

- Continue temporary lease to parking vendor
- Conduct geotech boring for bus link ramp
- Initiate Caltrans lease negotiations
- Complete WASSP Seismic Analysis
- Obtain Caltrans approval of PSR/PR
- Construction Documents



Schedule

- WASSP Seismic Analysis: Oct. 2010
- Advance Planning Studies: Aug. 2011
- Project Study Report (PSR/PR): Dec. 2011
- Construction Documents (CD's):
 - Complete 65% CD's Oct. 2011
 - Complete 95% CD's April 2012
- Procurement: May-Aug.2012
- Construction: Aug. 2012–Oct. 2013

CONTACT INFORMATION

Transbay Joint Powers Authority

201 Mission Street, Suite 2100

San Francisco, CA 94105

(415) 597-4620

www.transbaycenter.org

