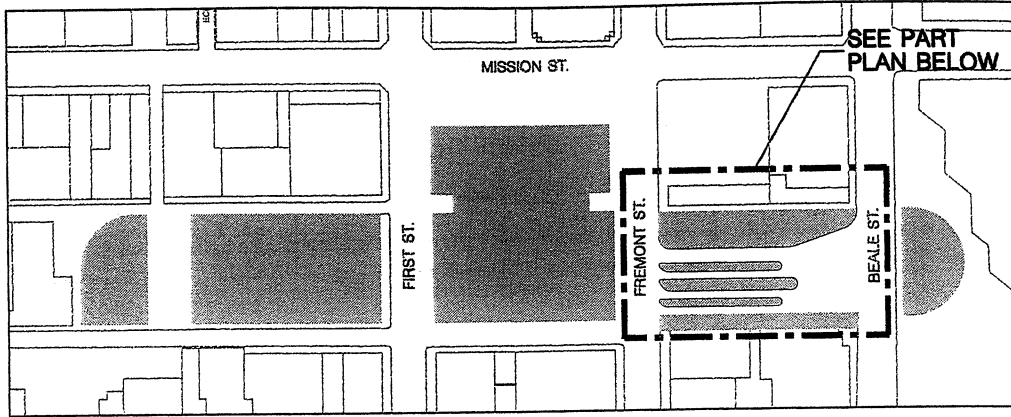
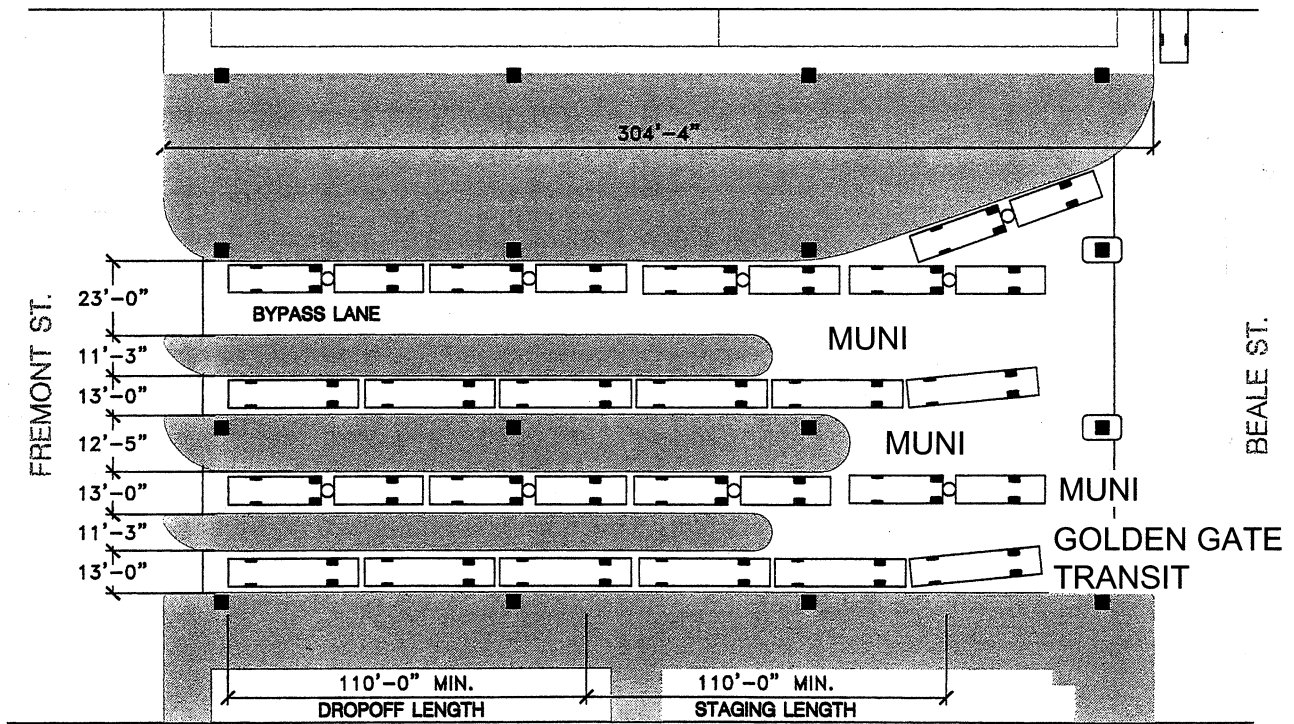

Figure 2.2-1: Transbay Terminal West Ramp Alternative Location of Terminal Components



PLAN AT ENTRY LEVEL



**Figure 2.2-2: Transbay Terminal- -
Muni and Golden Gate Transit Street-Level Facilities**

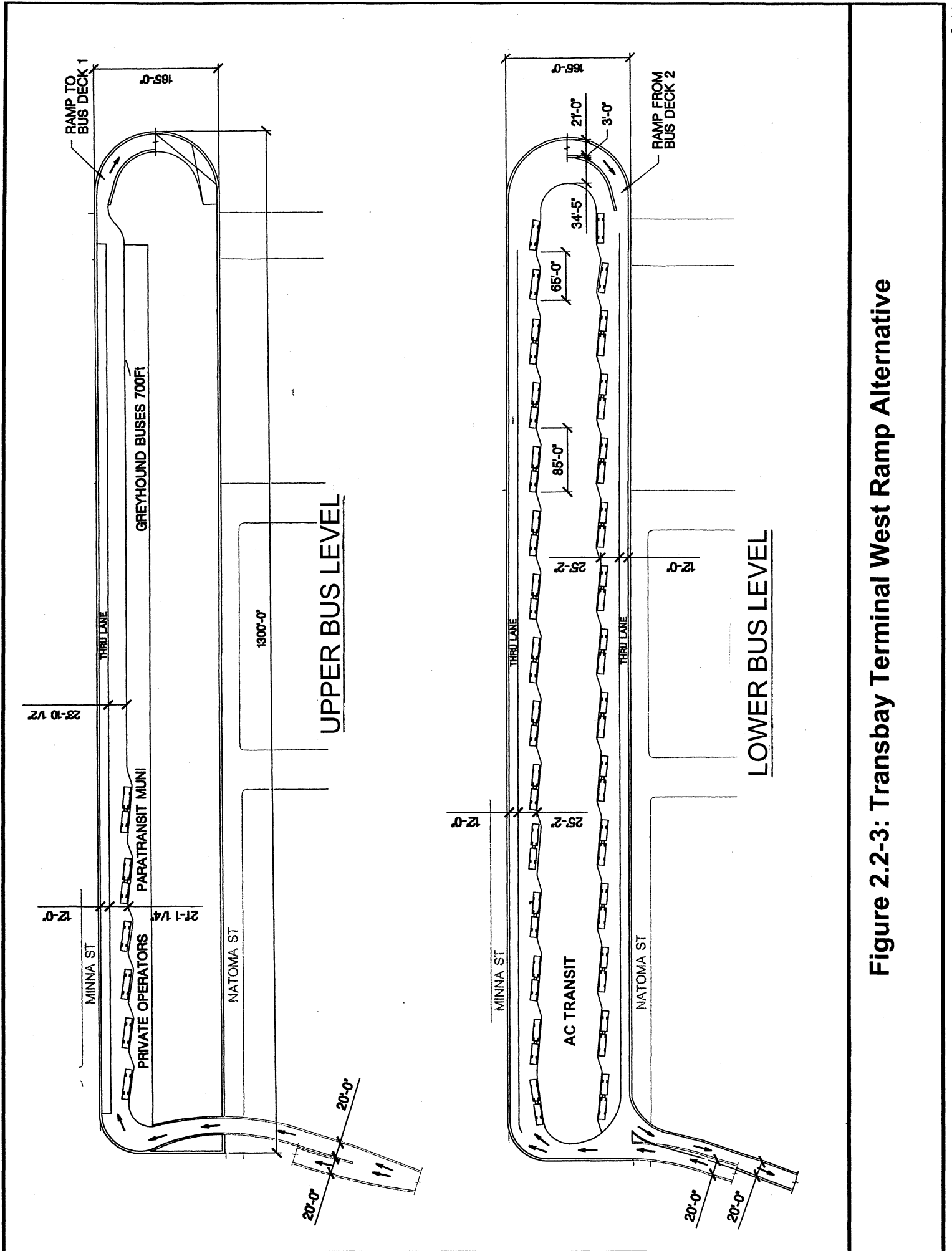

Figure 2.2-3: Transbay Terminal West Ramp Alternative



Fig 2A Existing Conditions

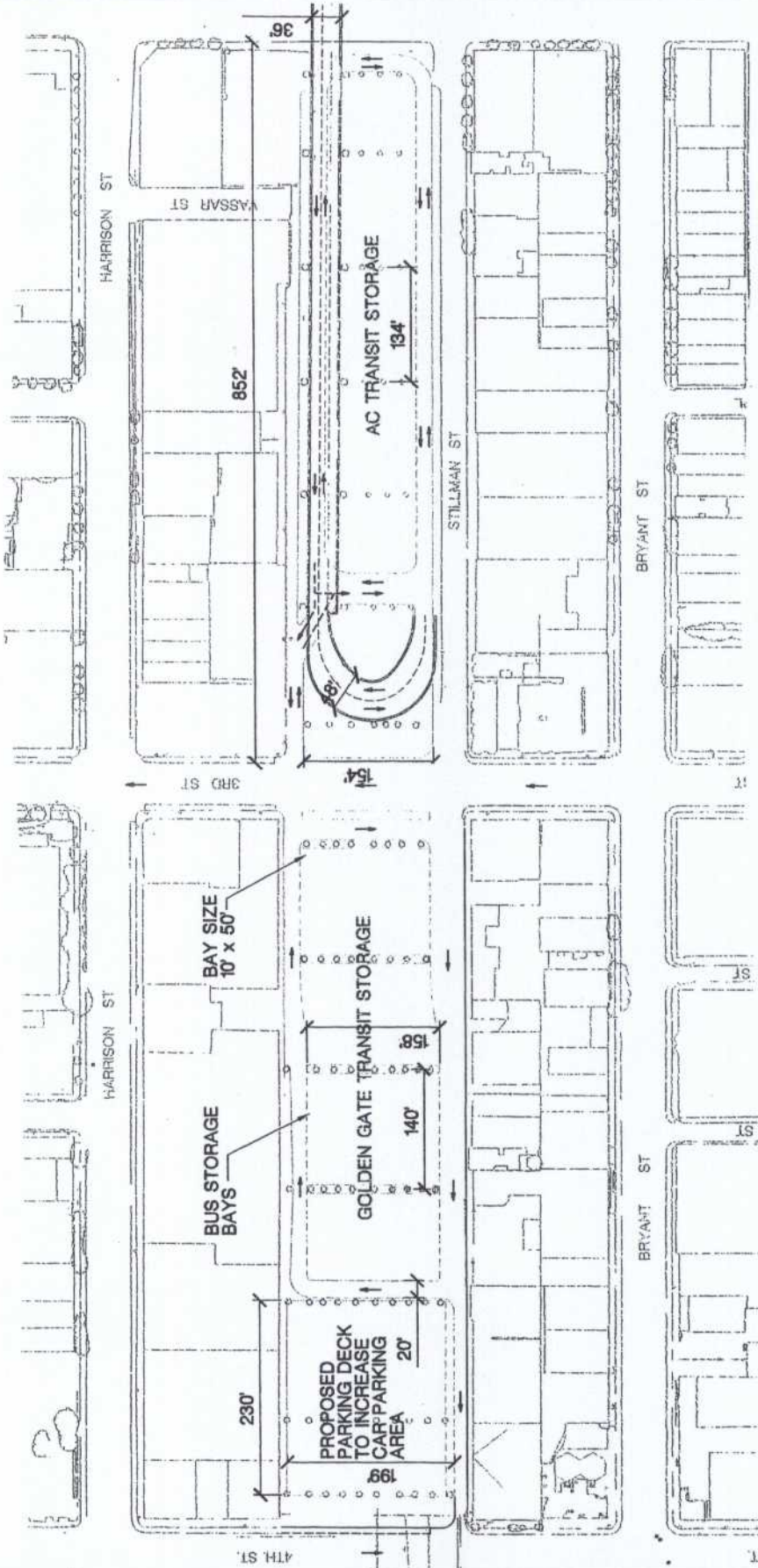

Fig 2B West Ramp Alternative

View from Howard Street
Near First Street
Looking Northwest

SOURCE: Parsons Transportation Group

Figure 2.2-4: Visual Simulation of Staked Ramps at Howard Street West Ramp Alternative



Not to Scale

Figure 2.2-5: Proposed Transbay Terminal Off-Site Bus Storage

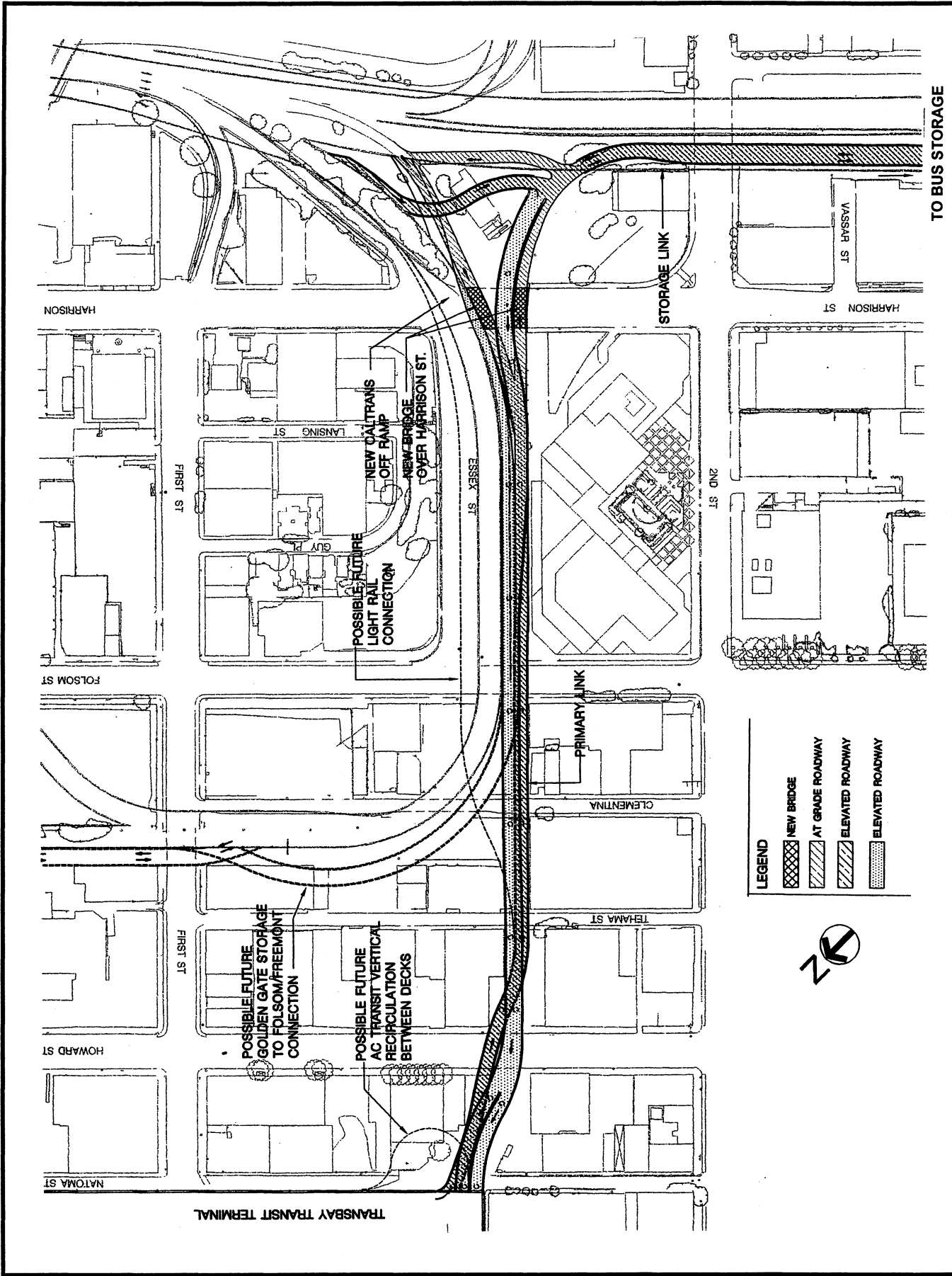
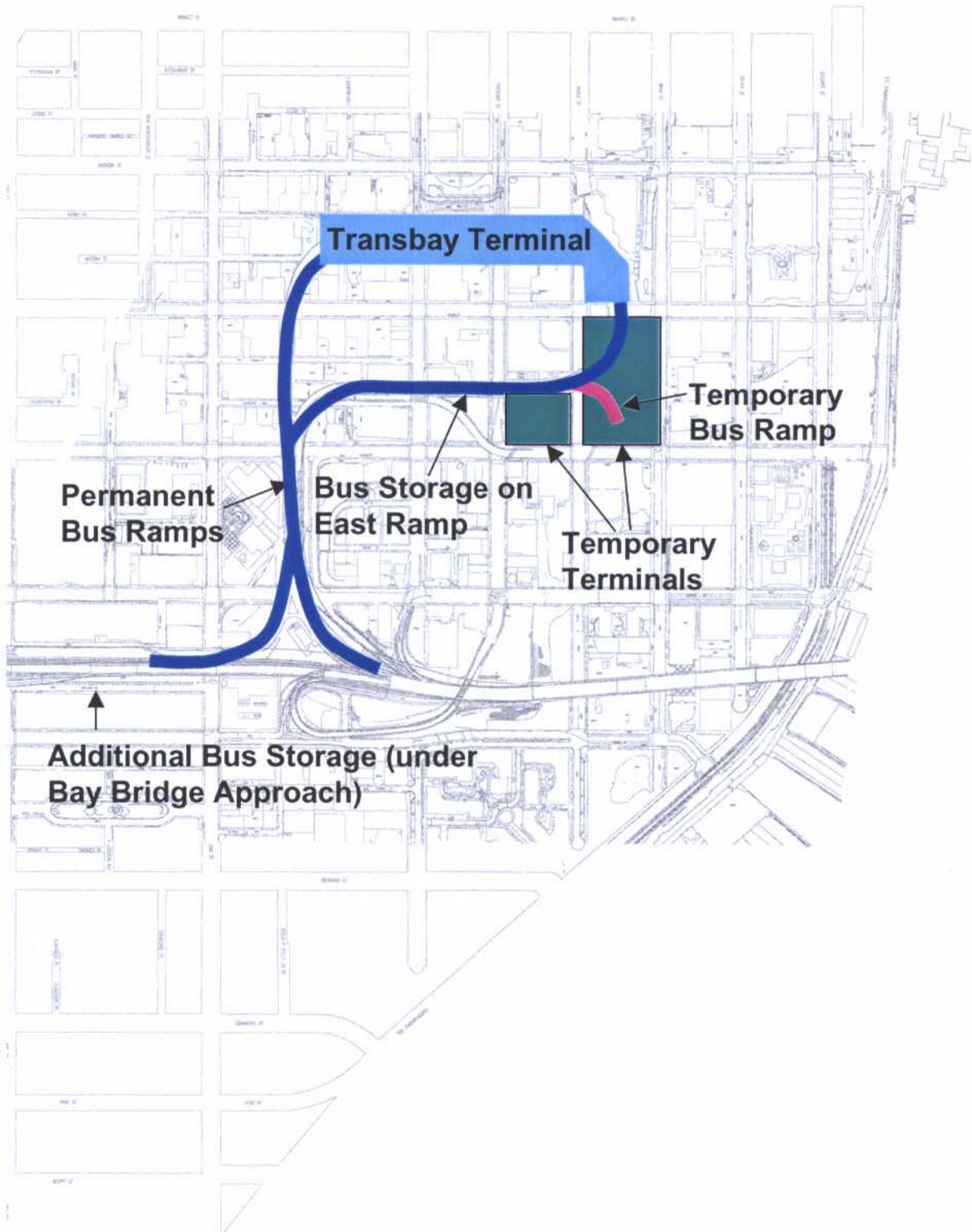

Figure 2.2-6: Transbay Terminal Off-Site Bus Storage Link Ramp



**Figure 2.2-7: Transbay Terminal Loop Ramp Alternative
Location of Terminal Components**

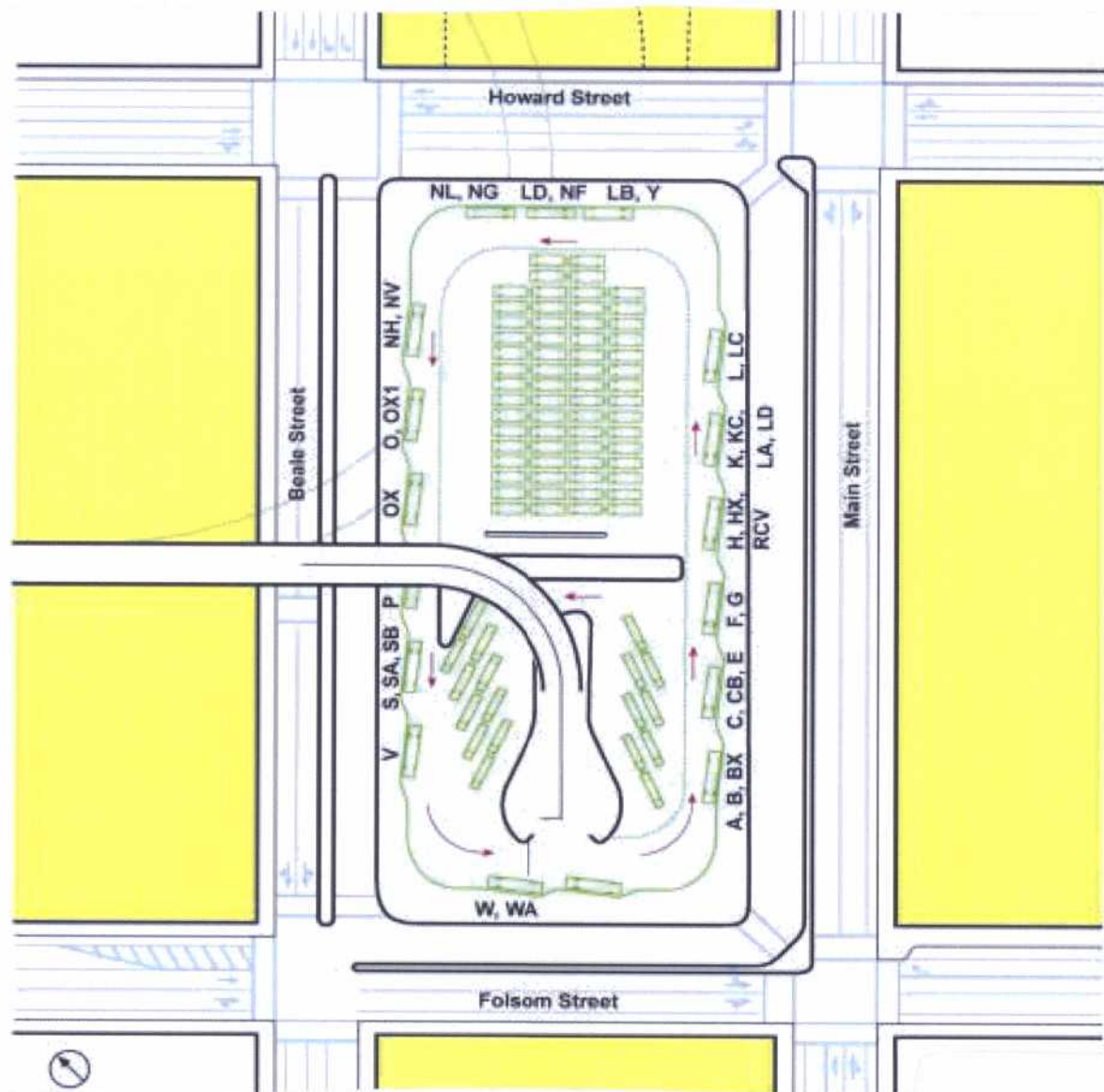

Figure 2.2-8: Layout of Temporary Bus Terminal



PLAN

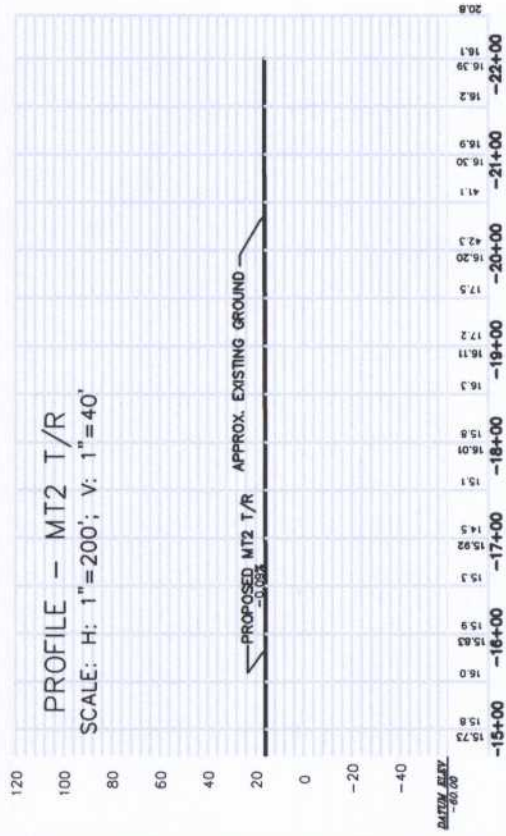
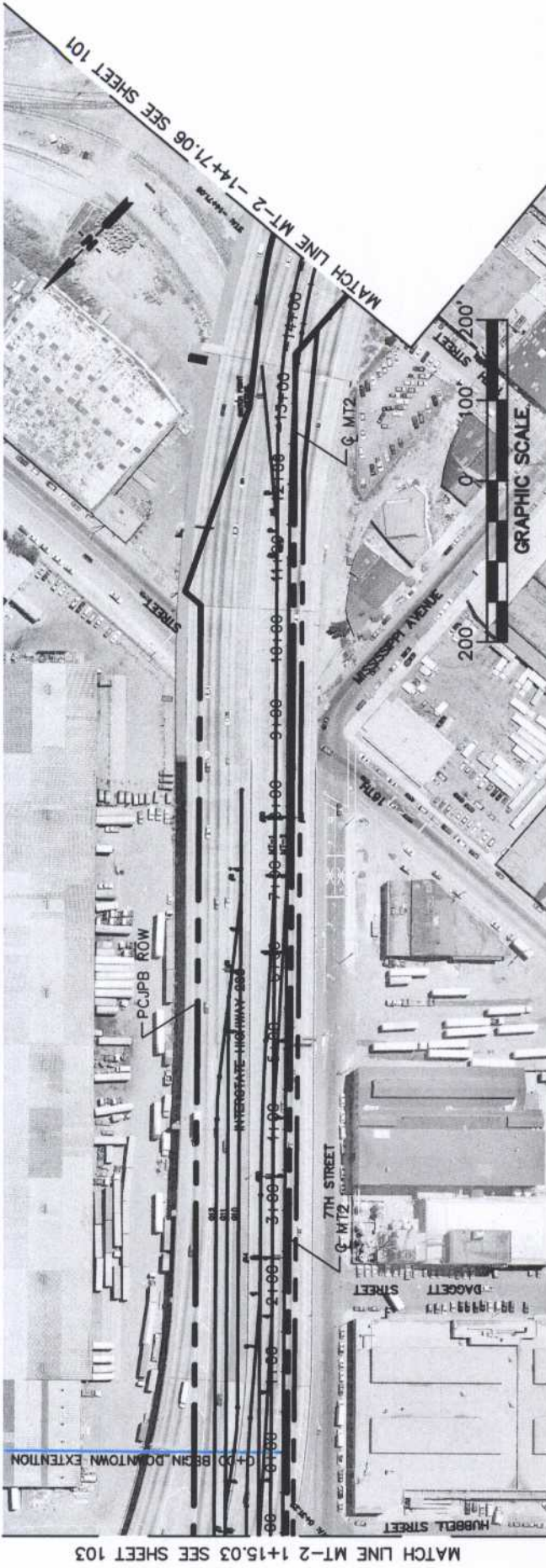

Figure 2.2-9

MATCH LINE MT-2 -14+71.06 SEE SHEET 102

DATE FLOWN	SEPTEMBER, 2000	DESIGNED BY	J. TENNYSON	CHECKED BY	D. MANSEN	DATE		PROJECT MANAGER	D. MAXEY	CONTRACT NO.	1"=200'	CADD FILE NO.	C-DTX1-B	CADD DATE	021902	
<p>SUBJECT TO CHANGE DURING FINAL DESIGN</p>								STRUCTURES	Z. AMARE	CONTRACT NO.		SCALE		<p>PENINSULA CORRIDOR JOINT POWERS BOARD</p> <p>SAN FRANCISCO</p> <p>CALTRAIN DOWNTOWN EXTENSION</p> <p>2ND TO MAIN and 2ND to MISSION</p> <p>SHEET 1 of 9</p>		
								TRACK / CIVIL	B. SUSANTO	DATE NO.	101	REV / PAGE NO.				
		<p>1200 5th Street, Suite 200 San Francisco, CA 94103</p>		<p>1200 5th Street, Suite 200 San Francisco, CA 94103</p>												



PLAN

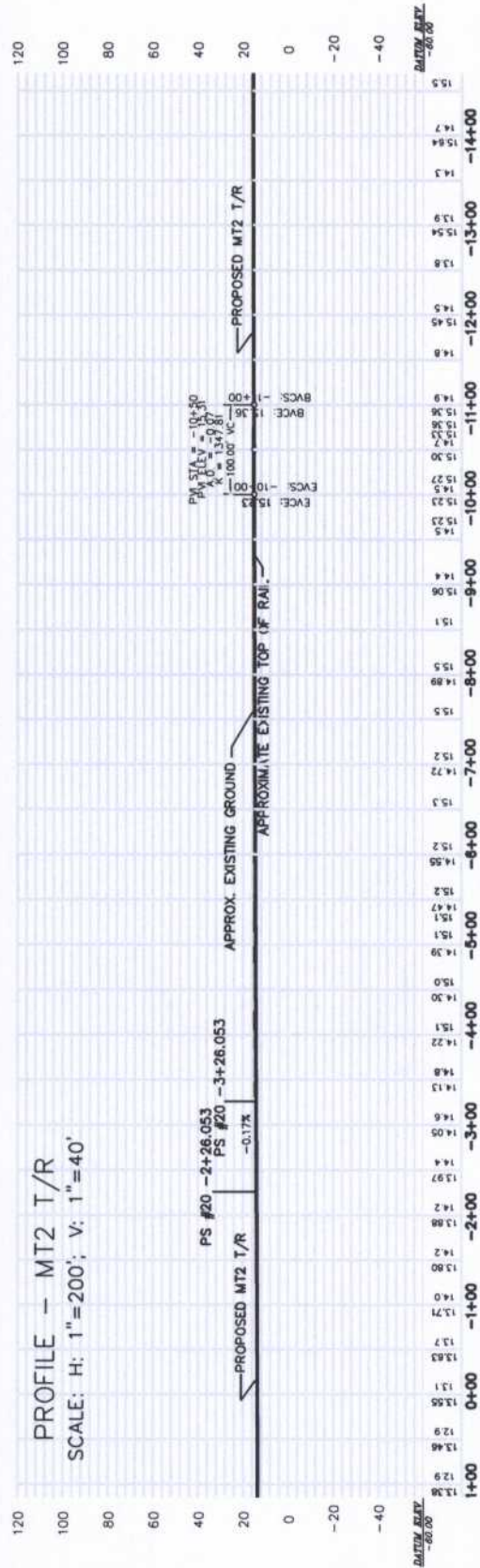

DATE FLOWN	SEPTEMBER, 2000	DESIGNED	J. TENNYSON	CHIEF ENGINEER	D. MAKEY	PROJECT MANAGEMENT	PENINSULA CORRIDOR JOINT POWERS BOARD		CADD FILE NO	C-07X1-B	CADD DATE	071902	
SUBJECT TO CHANGE DURING FINAL DESIGN				DRAWN	J. SHIN	STRUCTURES	SAN FRANCISCO CALTRAIN DOWNTOWN EXTENSION		SCALE	1" = 200'	CONTRACT NO.		
				CHECKED	D. MANSEN	TRACK / CIVIL	Z. AMARE	2ND to MAIN and 2ND to MISSION		CONTRACT NO.			
				IN CHARGE	D. WEMMER	TRACK / CIVIL	SHEET 2 of 9		DATE		ONE NO.	102	
				DATE		TRACK / CIVIL	SHEET 2 of 9		DATE		TWO NO.		
				APPROVED		B. SUSANTO							
				 1200 So. Orange Avenue San Jose, CA 95128		 1000 California Street San Francisco, CA 94109							

Figure 2.2-10

MATCH LINE MT-2 18+89.54 SEE SHEET 104

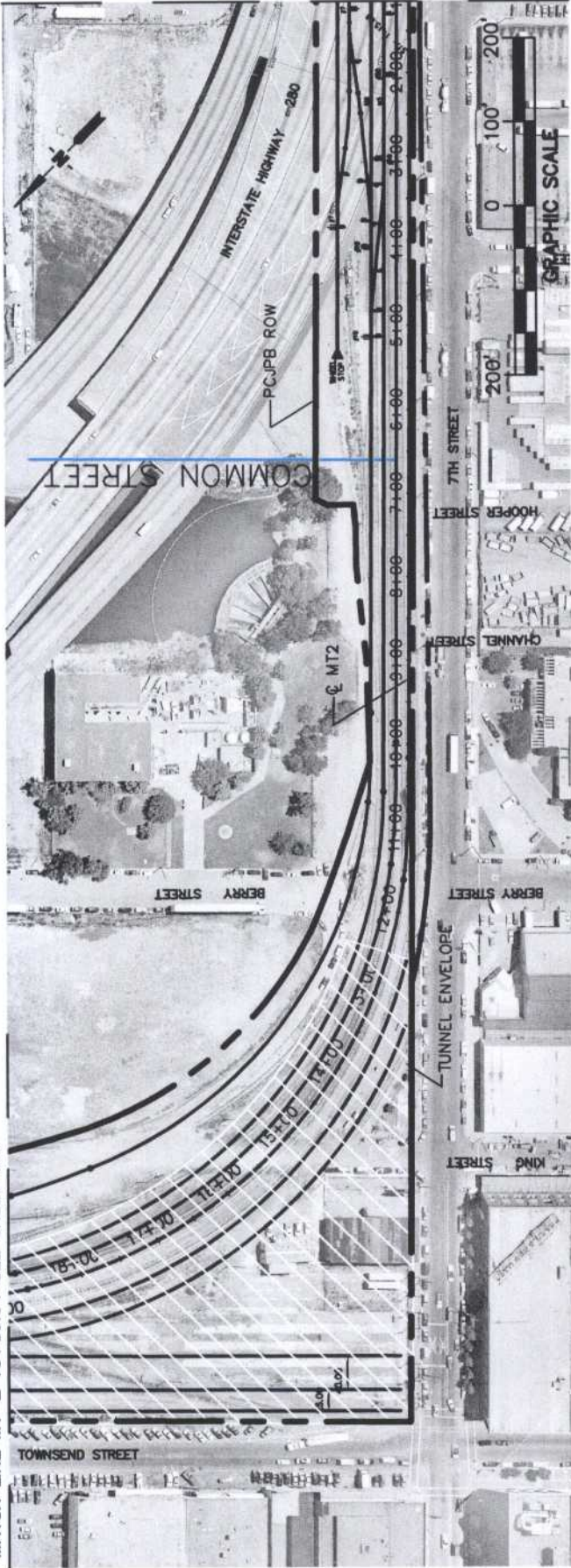

MATCH LINE MT-2 1+15.03 SEE SHEET 102

PLAN

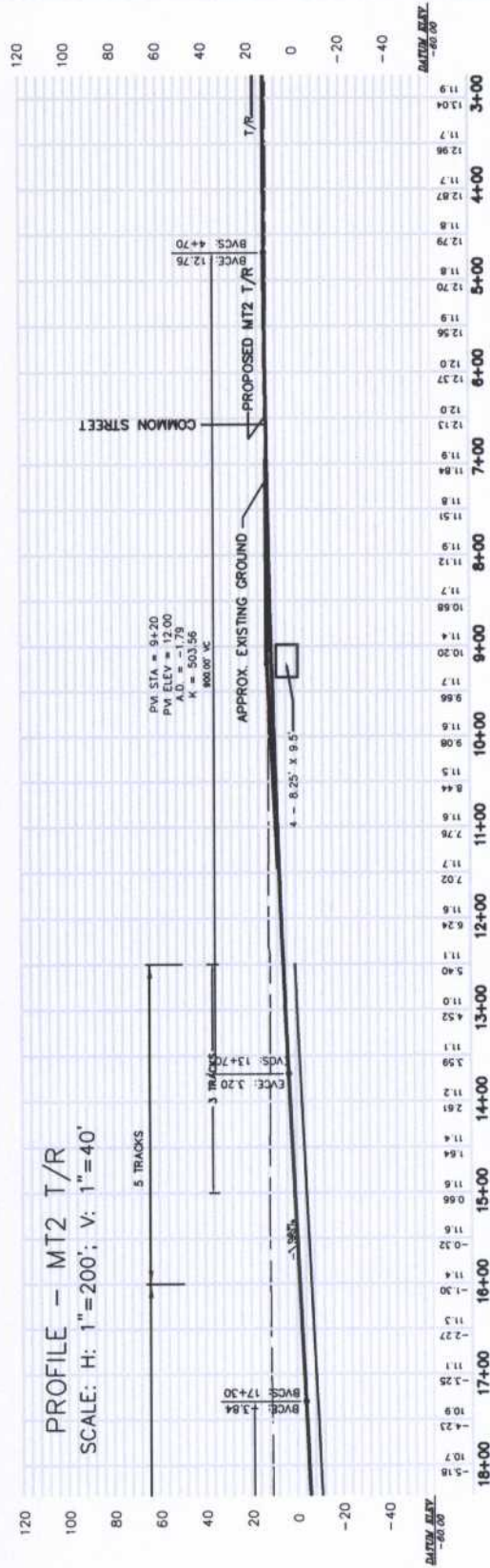

PROFILE -- MT2 T/R
SCALE: H: 1"=200'; V: 1"=40'

DATE FLOWN	SEPTEMBER, 2000	DESIGNED	J. TENNYSON	CADD FILE NO	C-07X1-B	CADD DATE	02/19/02
<p>SUBJECT TO CHANGE DURING FINAL DESIGN</p>				<p>SAN FRANCISCO CALTRAIN DOWNTOWN EXTENSION 2ND TO MAIN and 2ND TO MISSION SHEET 3 of 9</p>			
				<p>SCALE: 1"=200'</p>	<p>CONTRACT NO</p>	<p>WORKSHEET</p>	<p>DWG NO</p>
<p>PROJECT MANAGEMENT</p>		<p>STRUCTURES</p>		<p>TRACK / CIVIL</p>		<p>103</p>	
<p>D. MAXEY</p>		<p>Z. AMARE</p>		<p>B. SUSANTO</p>		<p>103</p>	
<p>PARSONS</p>		<p>1500 San Carlos Avenue San Carlos, CA 95050</p>		<p>1500 San Carlos Avenue San Carlos, CA 95050</p>		<p>103</p>	

Figure 2.2-11

MATCH LINE MT-2 37+60.15 SEE SHEET 105

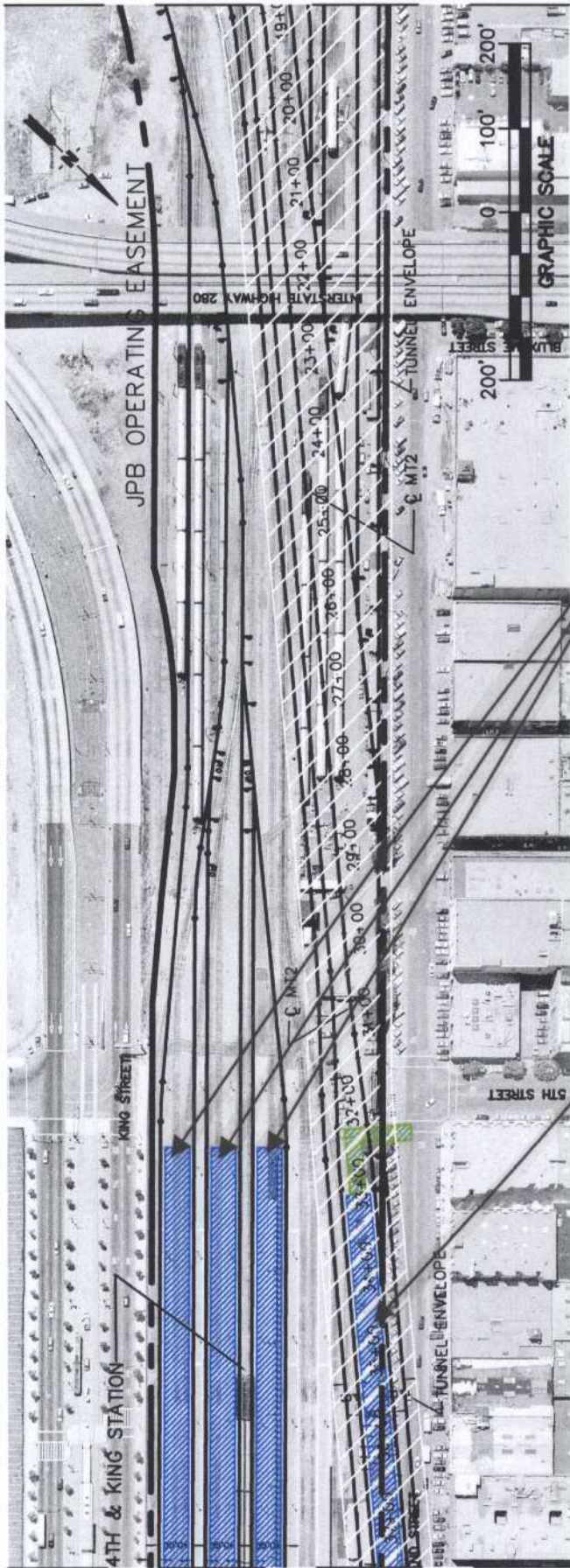

MATCH LINE MT-2 18+89.54 SEE SHEET 103

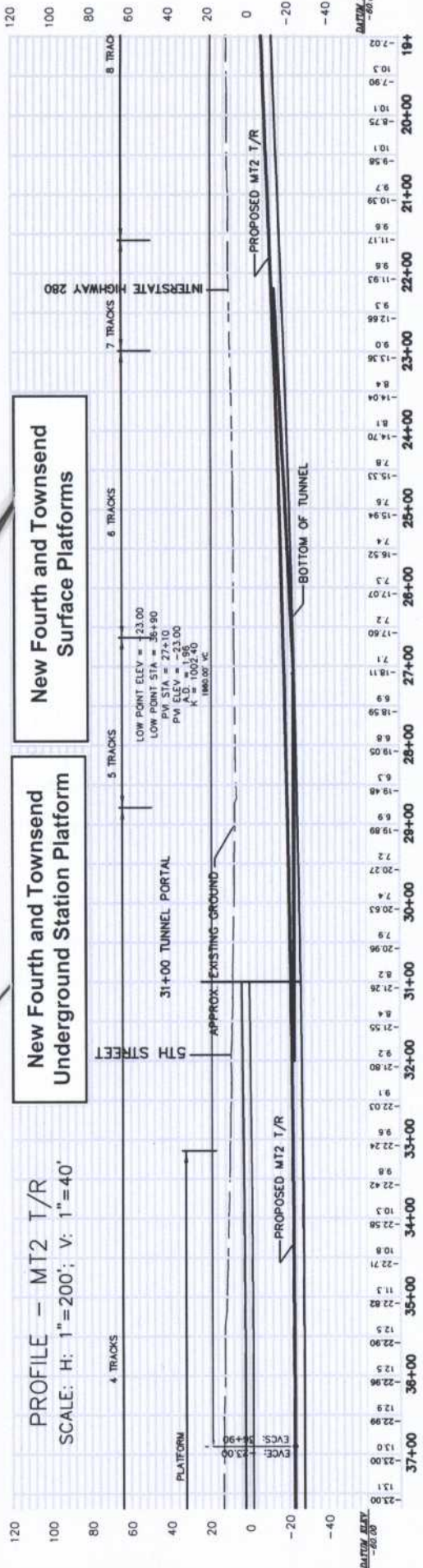

New Fourth and Townsend Underground Station Platform

New Fourth and Townsend Surface Platforms

DATE FLOWN SEPTEMBER, 2000

DESIGNED BY J. TENNYSON

DRAWN BY J. SHIN

CHECKED BY D. MANSSEN

IN CHARGE BY D. WEFUMER

DATE

SUBJECT TO CHANGE DURING FINAL DESIGN

Figure 2.2-12



CHIEF ENGINEER
D. MAKEY

PROJECT MANAGER
Z. AMARE

TRACK / CIVIL
B. SUSANTO

PENINSULA CORRIDOR JOINT POWERS BOARD

SAN FRANCISCO
CALTRAIN DOWNTOWN EXTENSION
2ND TO MAIN AND 2ND TO MISSION
SHEET 4 of 9

CADD FILE NO C-DTX1-B
CADD DATE 021902

SCALE 1"=200'

CONTRACT NO

MAP/PORT

DWG NO 104

REV FACE NO