

# **Transbay Transit Center Art Program**

In May 2008, TJPA approved the establishment of a public art program budget of \$4.75 million, managed and overseen by the Arts Commission under the guidance of the Public Art Steering Committee.

Members include:

- Maria Ayerdi-Kaplan, TJPA Executive Director
- Luis R. Cancel, Director of Cultural Affairs of the SFAC
- Fred Clarke, Pelli Clarke Pelli Architects
- Commissioner JD Beltran, Vice President of the Arts Commission, Artist, and Professor at the San Francisco Art Institute
- Blake Summers, Director and Chief Curator, San Francisco International Airport Museums and Exhibition Program

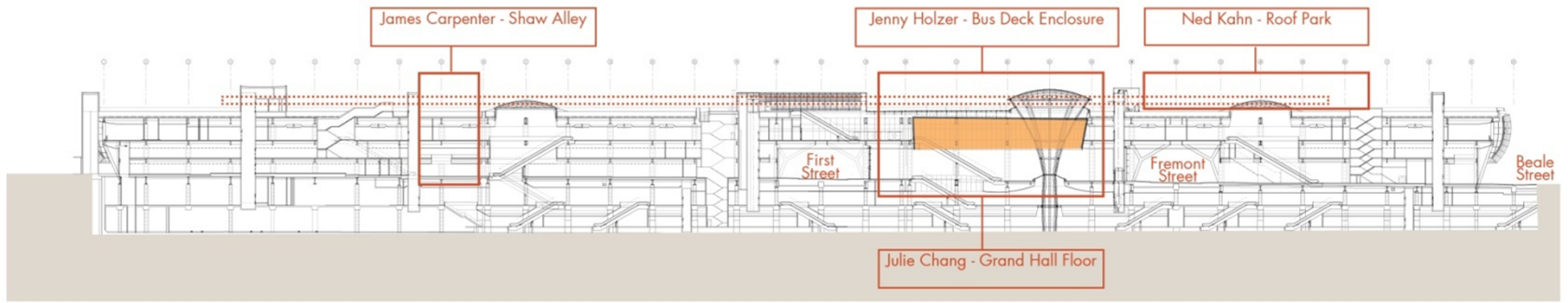

TTC ARTS SECTION LOCATION DIAGRAM

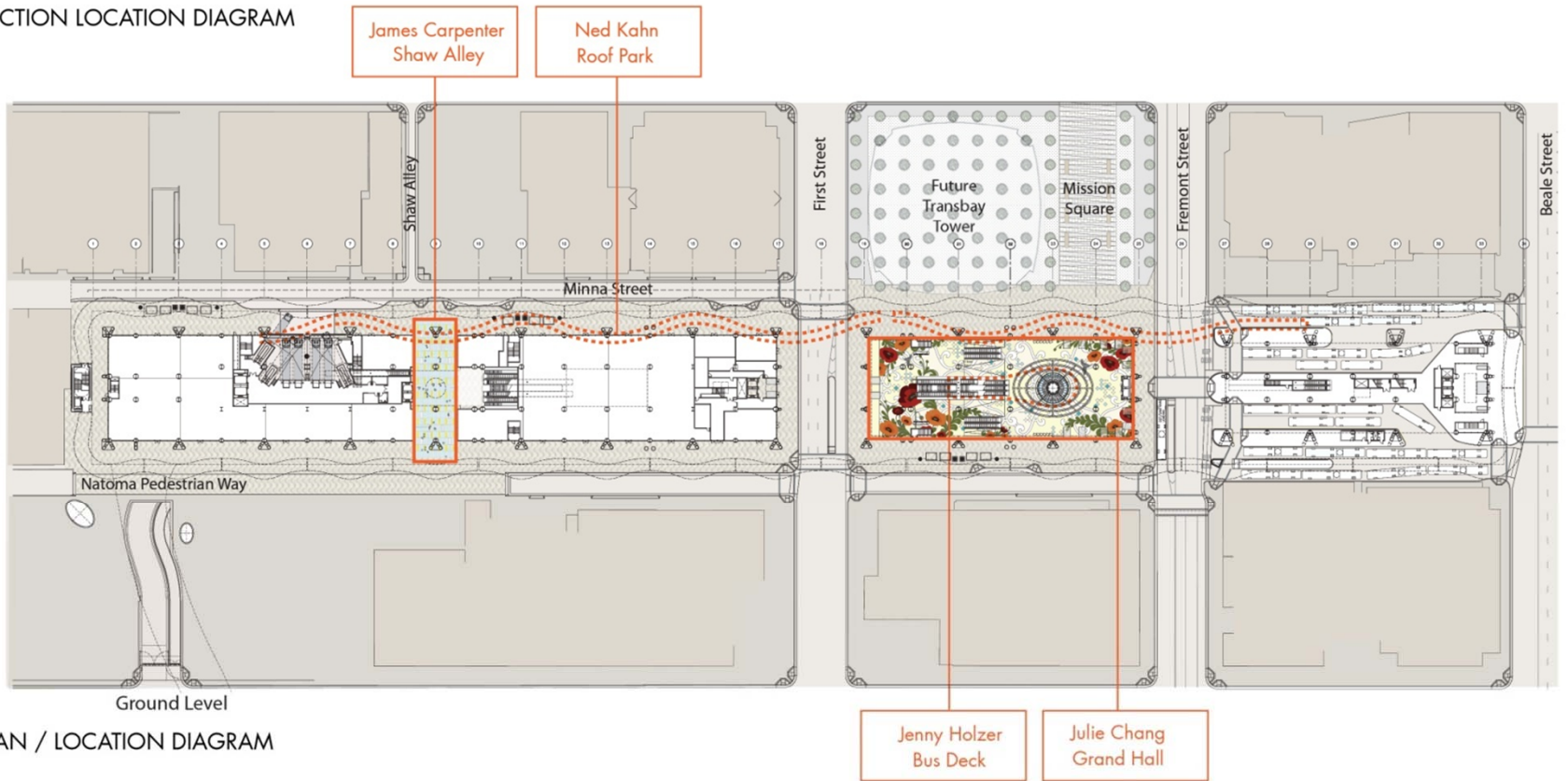

TTC ARTS PLAN / LOCATION DIAGRAM



Day Concept View



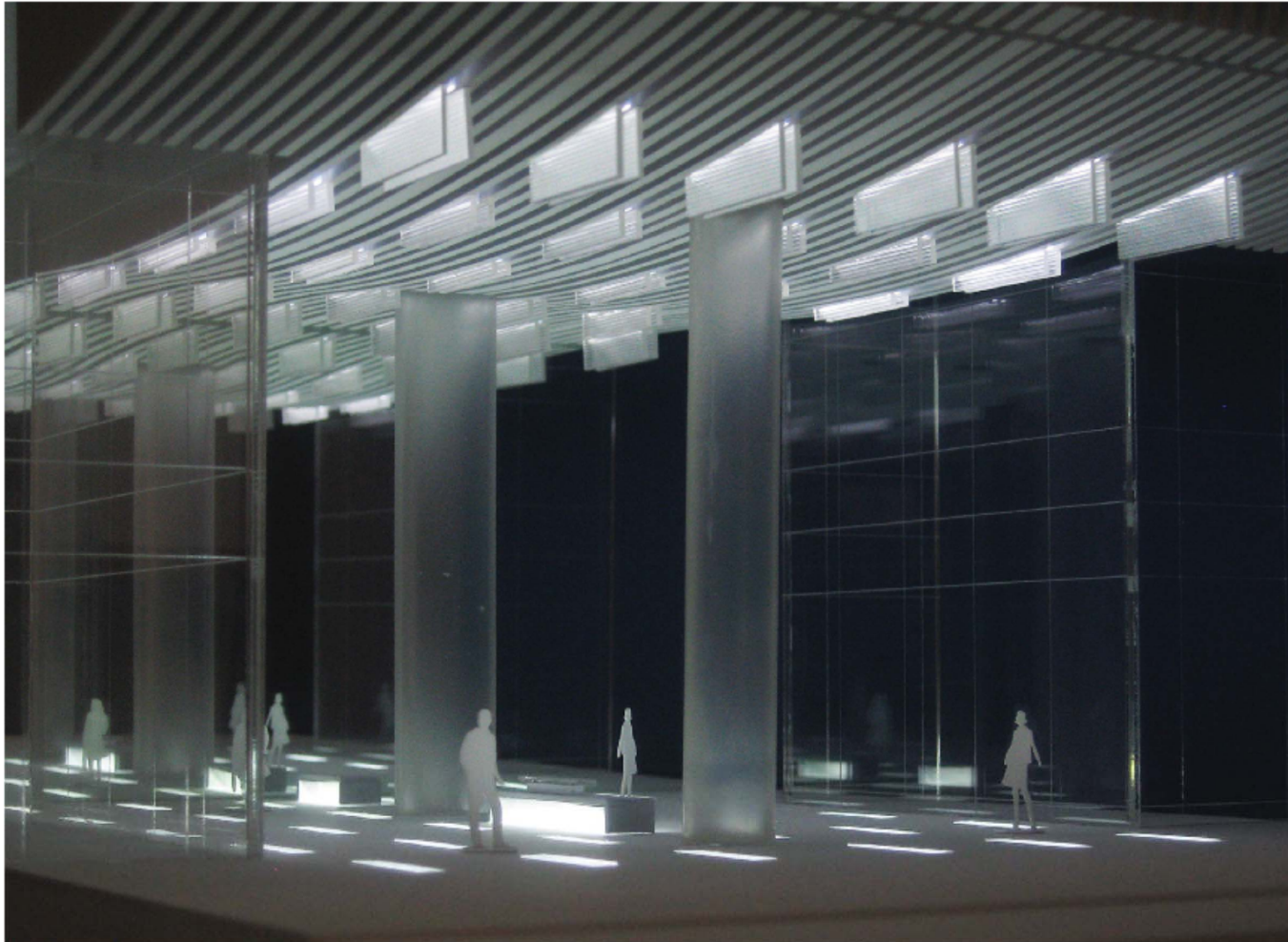

Night Concept View













JENNY HOLZER LED INSTALLATION AT BUS LEVEL (90')

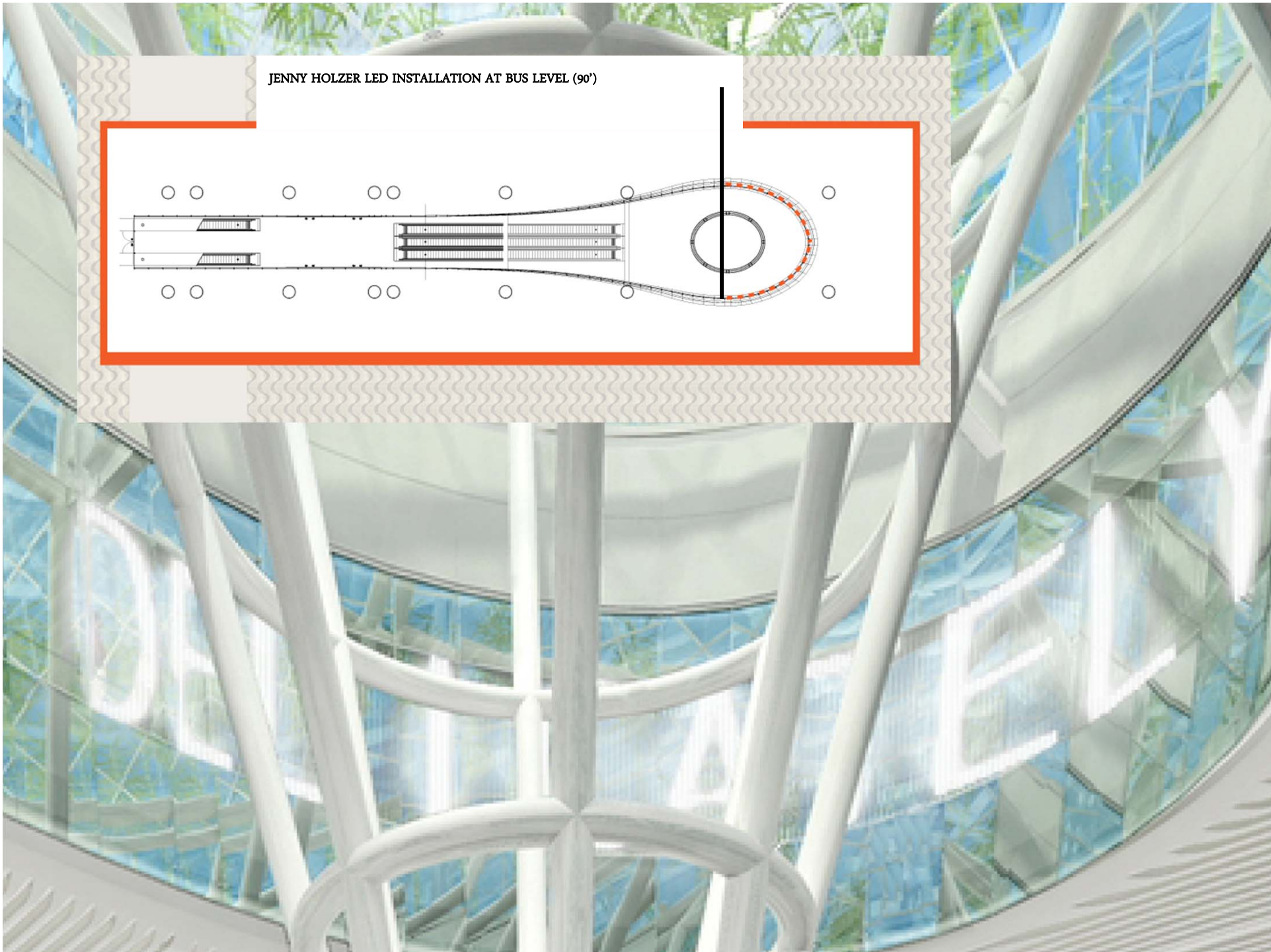
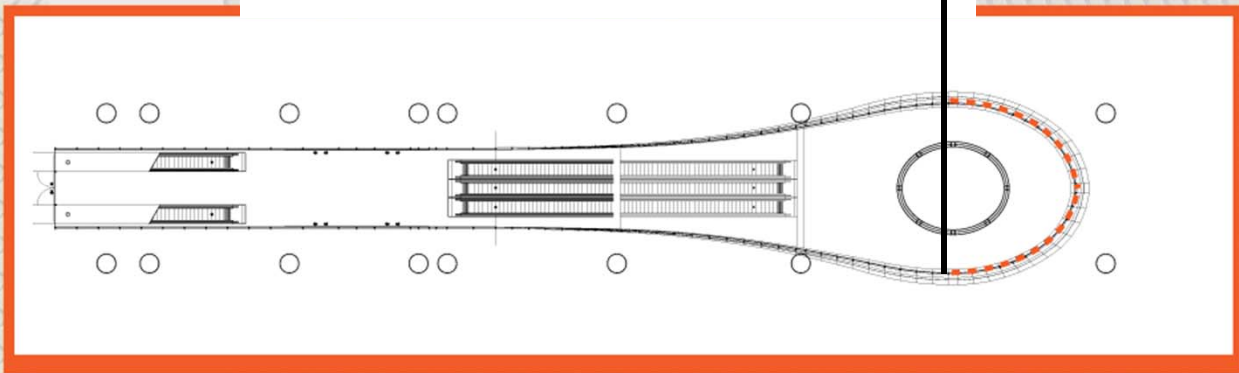

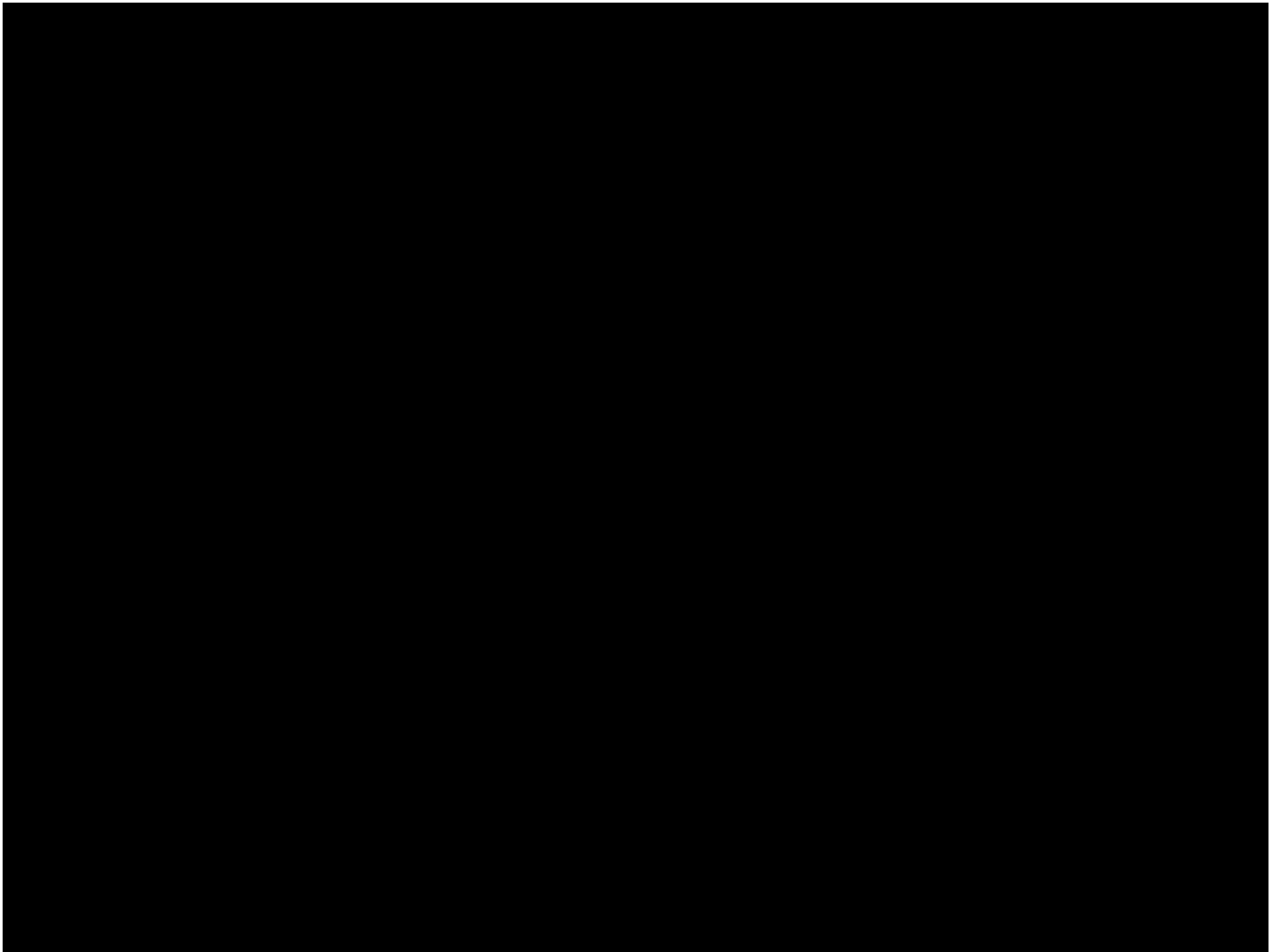







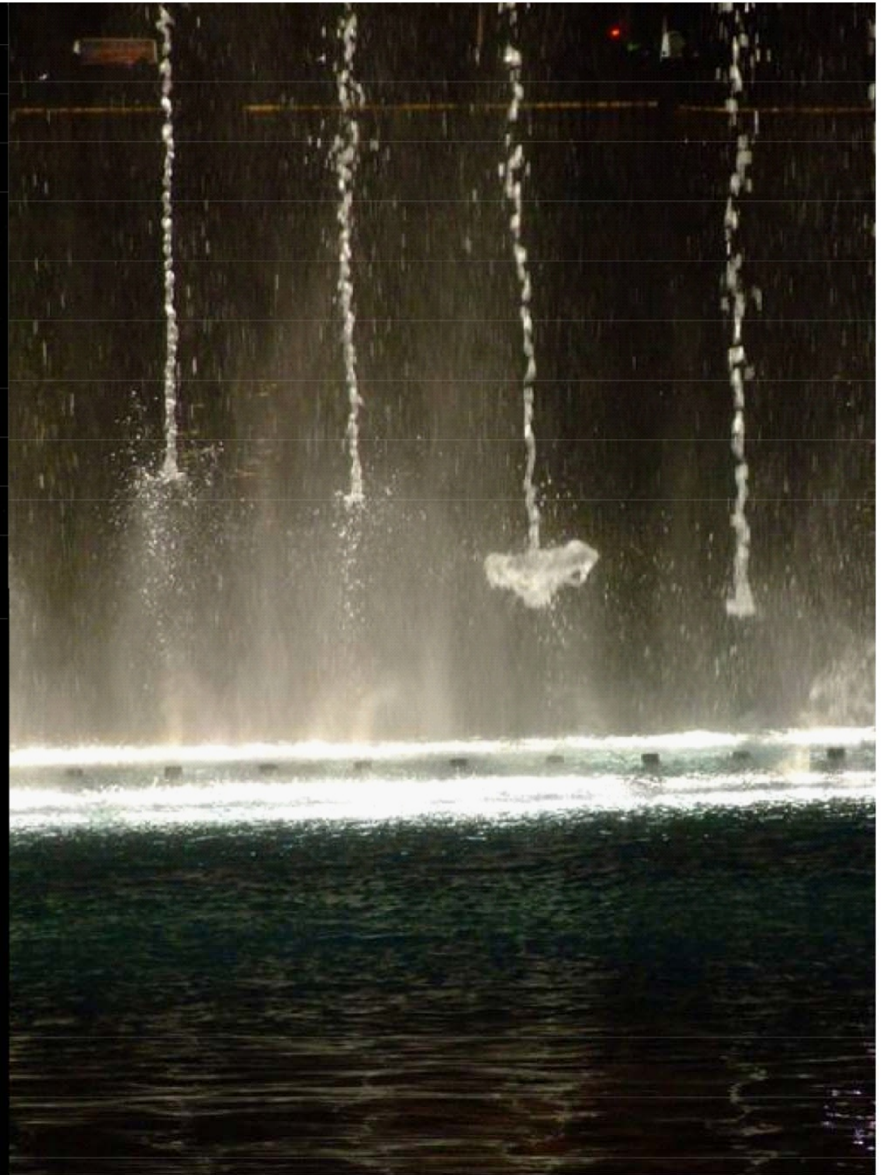
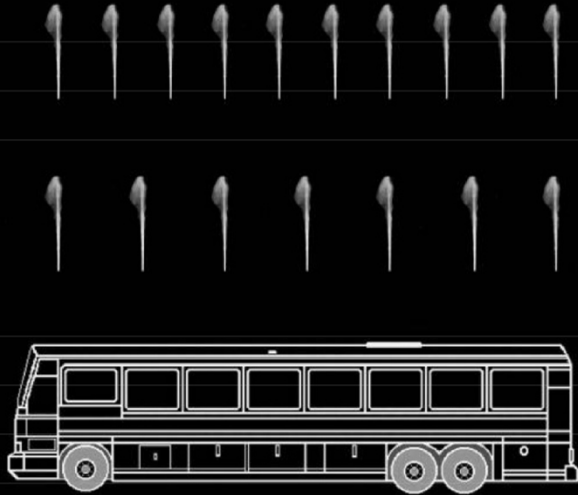





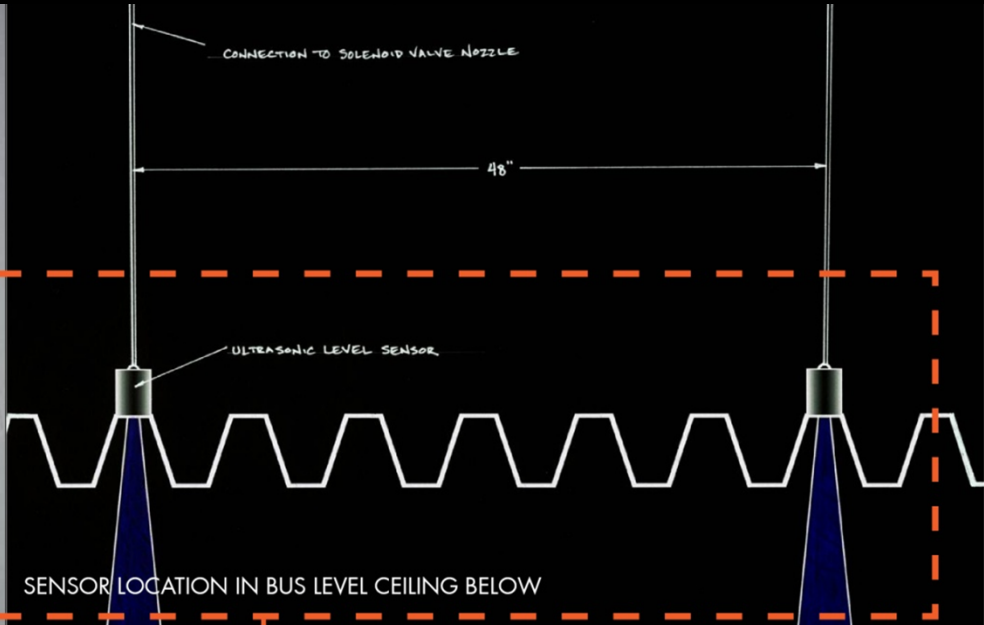

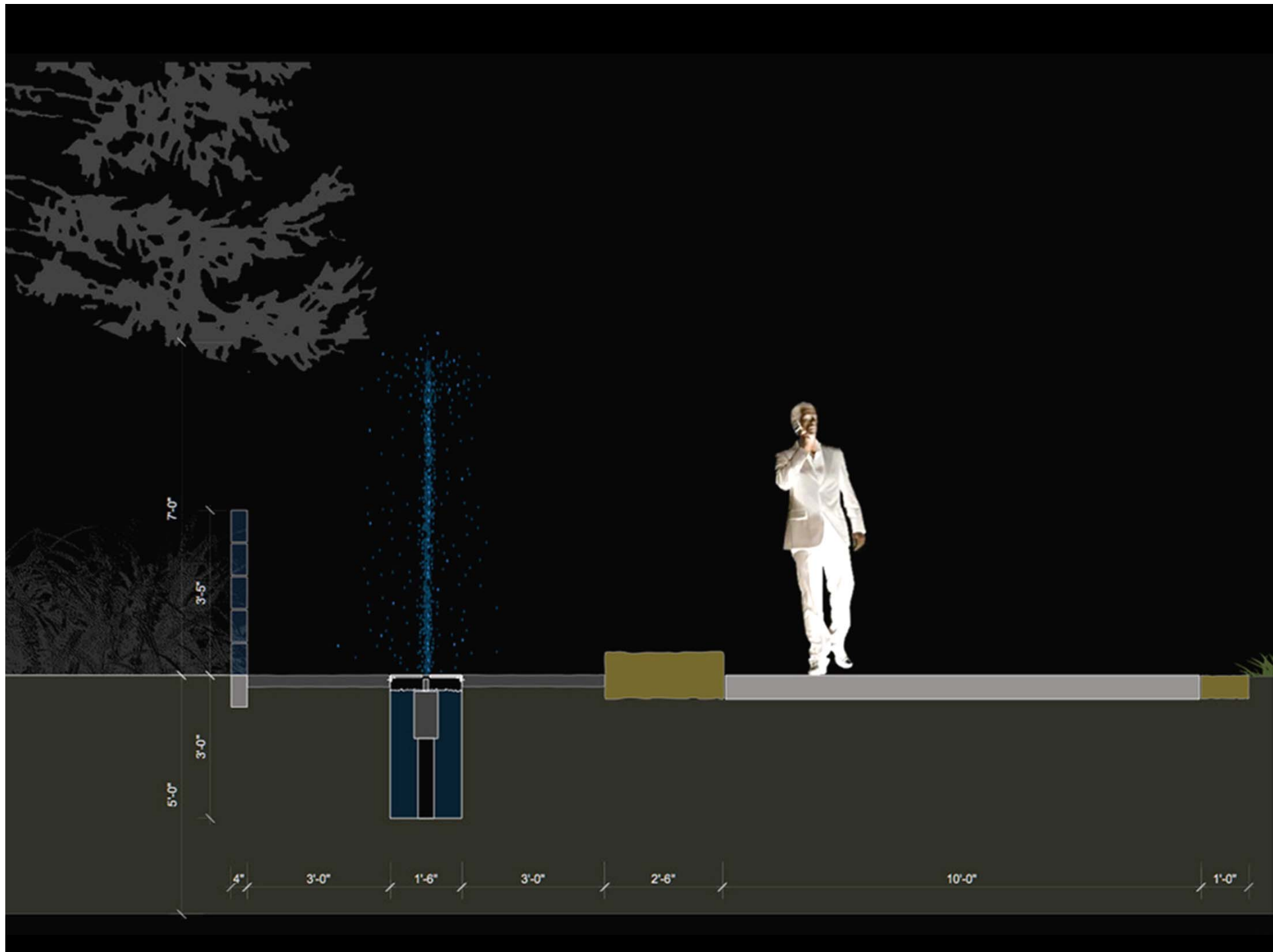



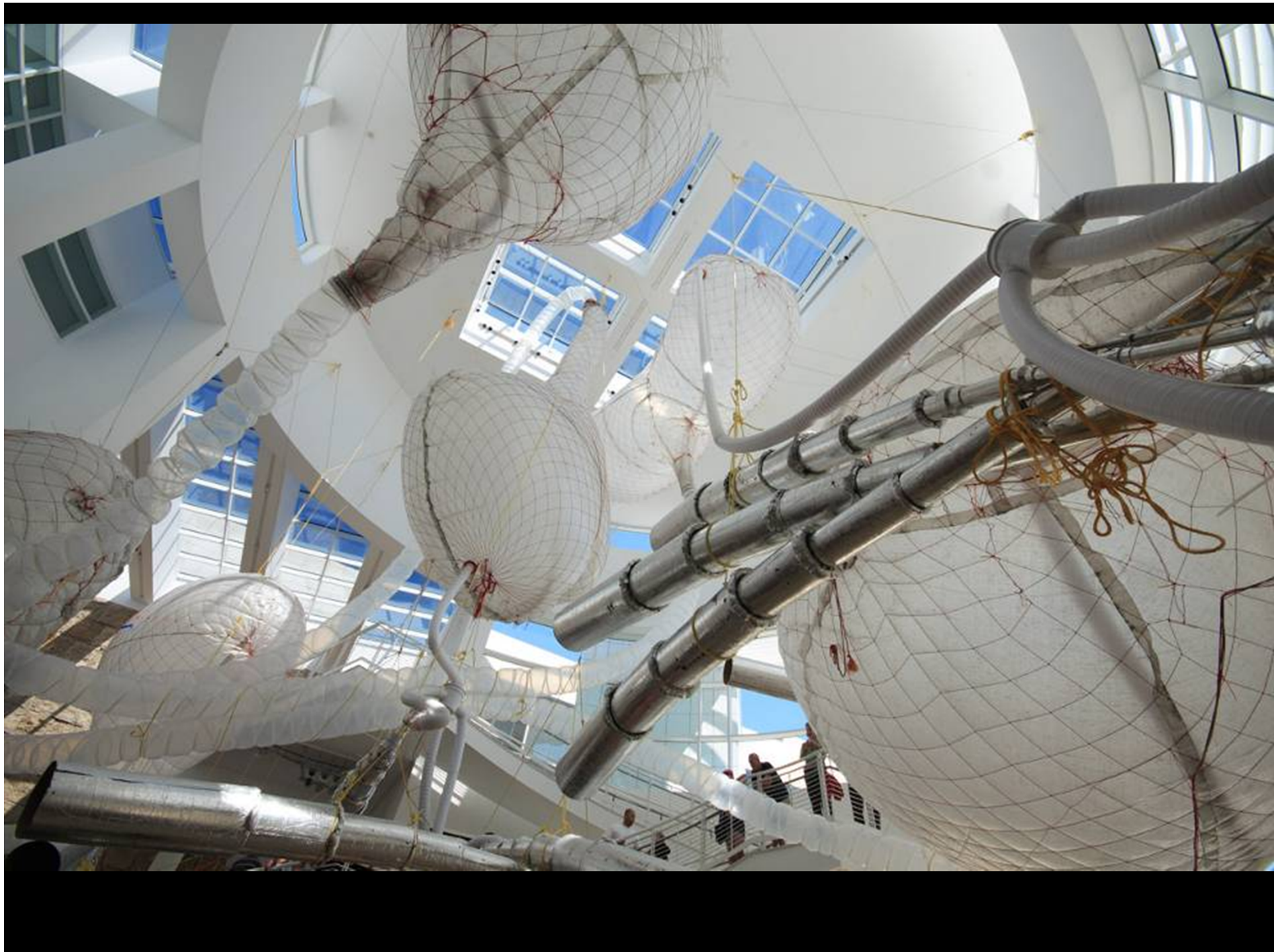







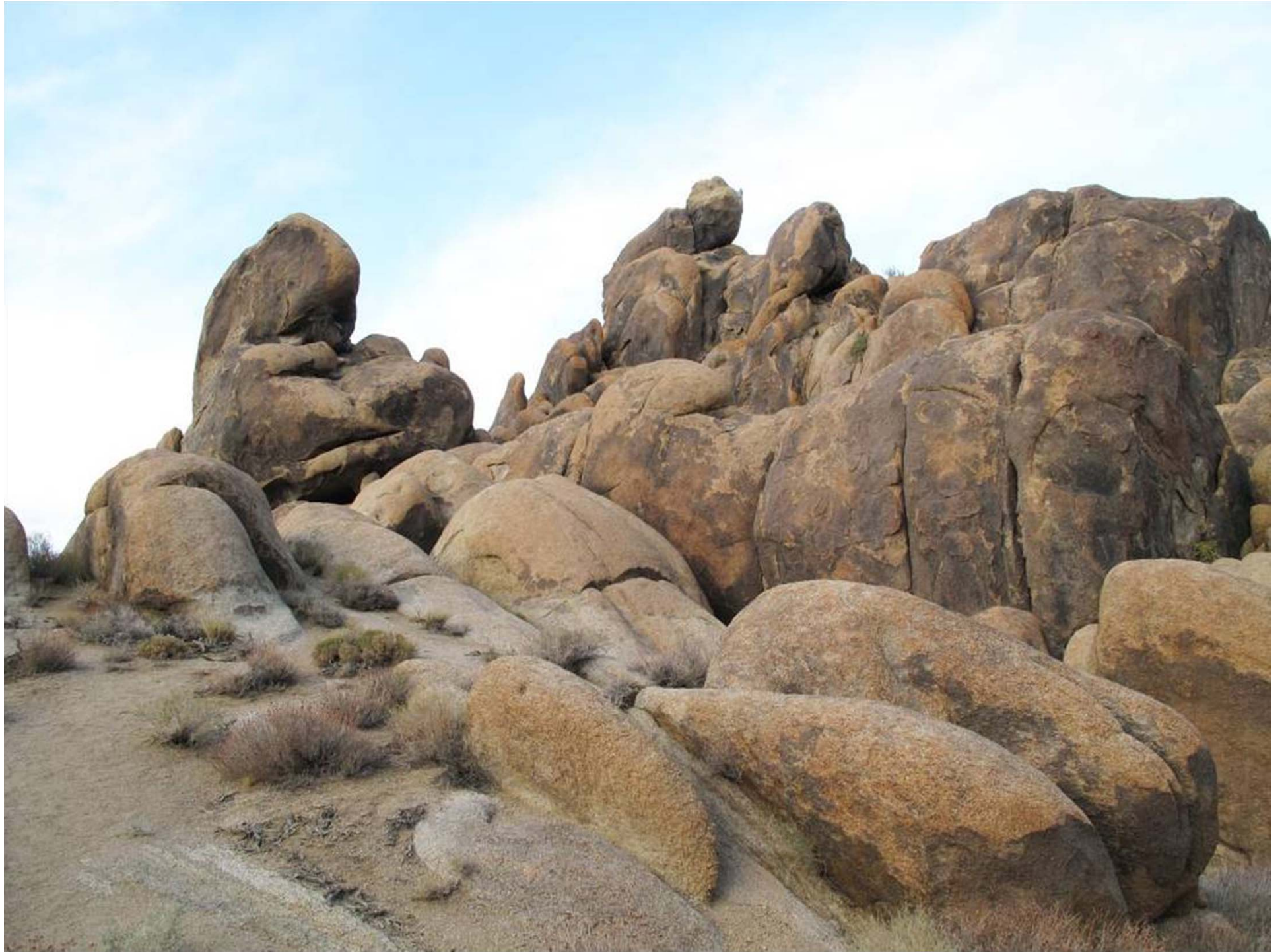





















tuari, e soprattutto del  
presenta visibilmente la  
niti di allora. Degli altri  
nati incendiati, altri  
nte distrutti nel corso  
giazioni della città;  
ancora il soffitto, e la  
lto: dopo la distruzione  
i di Akragas furono in  
nare i lavori.  
quaranta piedi, largo  
senza il crepidoma, è  
a ragione potrebbe  
on quelli di fuori per  
n. E, anche se non si  
pimento l'intero  
naria è ben visibile,  
scempi vengono  
inno, oppure sono  
o alle celle, questo  
i di costruzione:  
no stati eretti i  
alla parte esterna,  
no sezione  
nza della parte  
lle scanalature  
ente un corpo  
lla parte interna  
no di grandezza  
ne orientale  
con sculture di  
za, e in quella  
si può vedere  
doto  
la peristasi.

di E. Labriola.



Consenti, ti soggi  
che nelle case tranqui  
e dei Tirreni desisti  
che vide la su  
gomer per le nav  
e quale danno  
dal princip  
che dalle  
la loro gioventù  
strappando al grave  
Avrò com  
da Salamina.  
degli Aten  
dirò la battaglia  
là dove perirono i  
e presso la  
dalle limpide  
comparsi per  
tributo  
per cui po

Padano, Piteche 171-181.

O Clio dai dolci  
signora dell  
e la Fanciul  
e le caval  
nella cernia d  
lungo l'Al  
con la Vittor  
e al felice  
luggi fece  
e un tr  
-Fe  
che  
opere e vi  
ed il casto



TRANSBAY TRANSIT TERMINAL



GOVINT

5  
6  
108



Left arm from Phase III





Left Arm from Phase  
III demolition

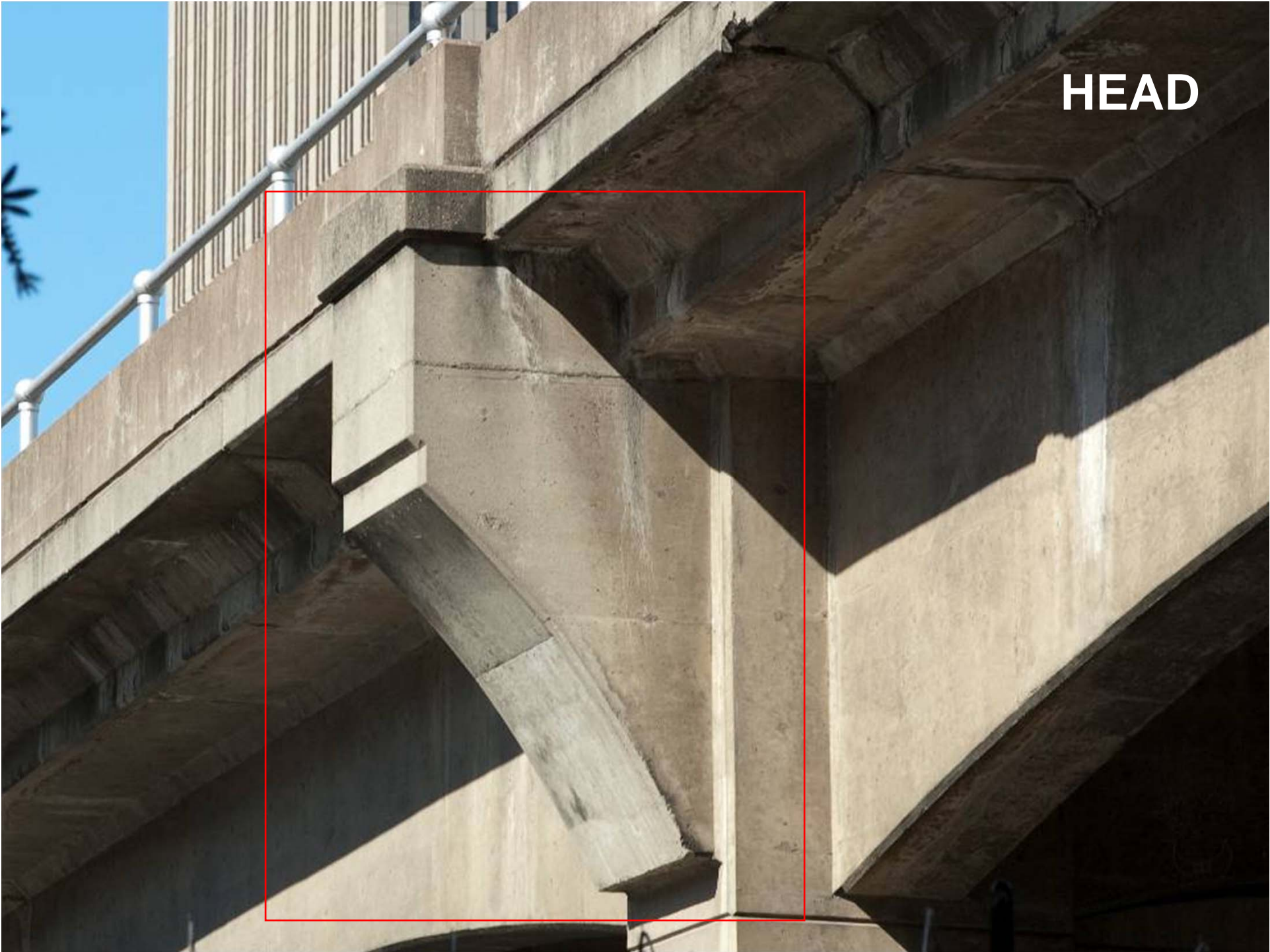

HEAD

**TORSO and HIPS**





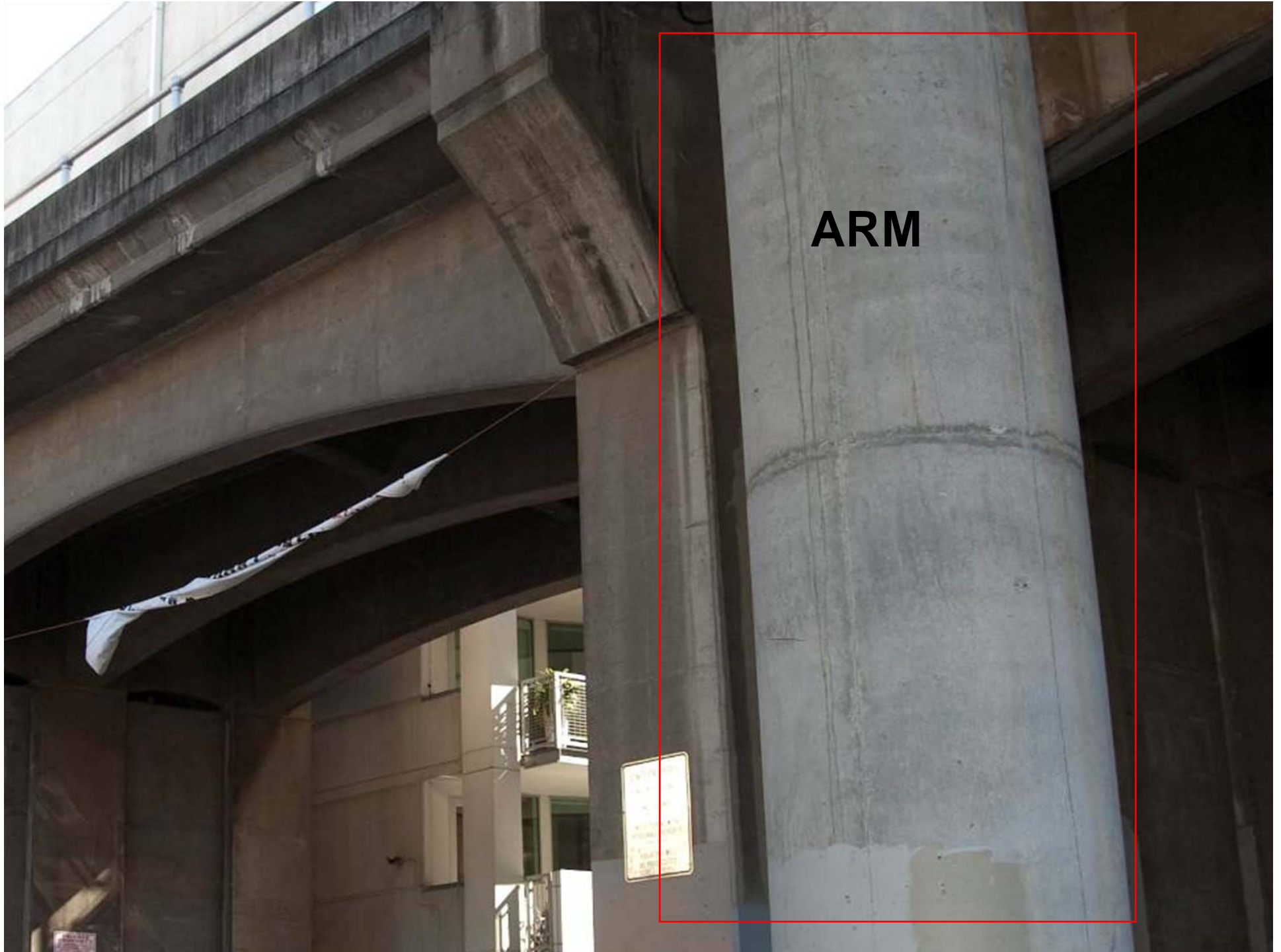

**ARM**

**FOREARM**



**LEG**





**FOOT**

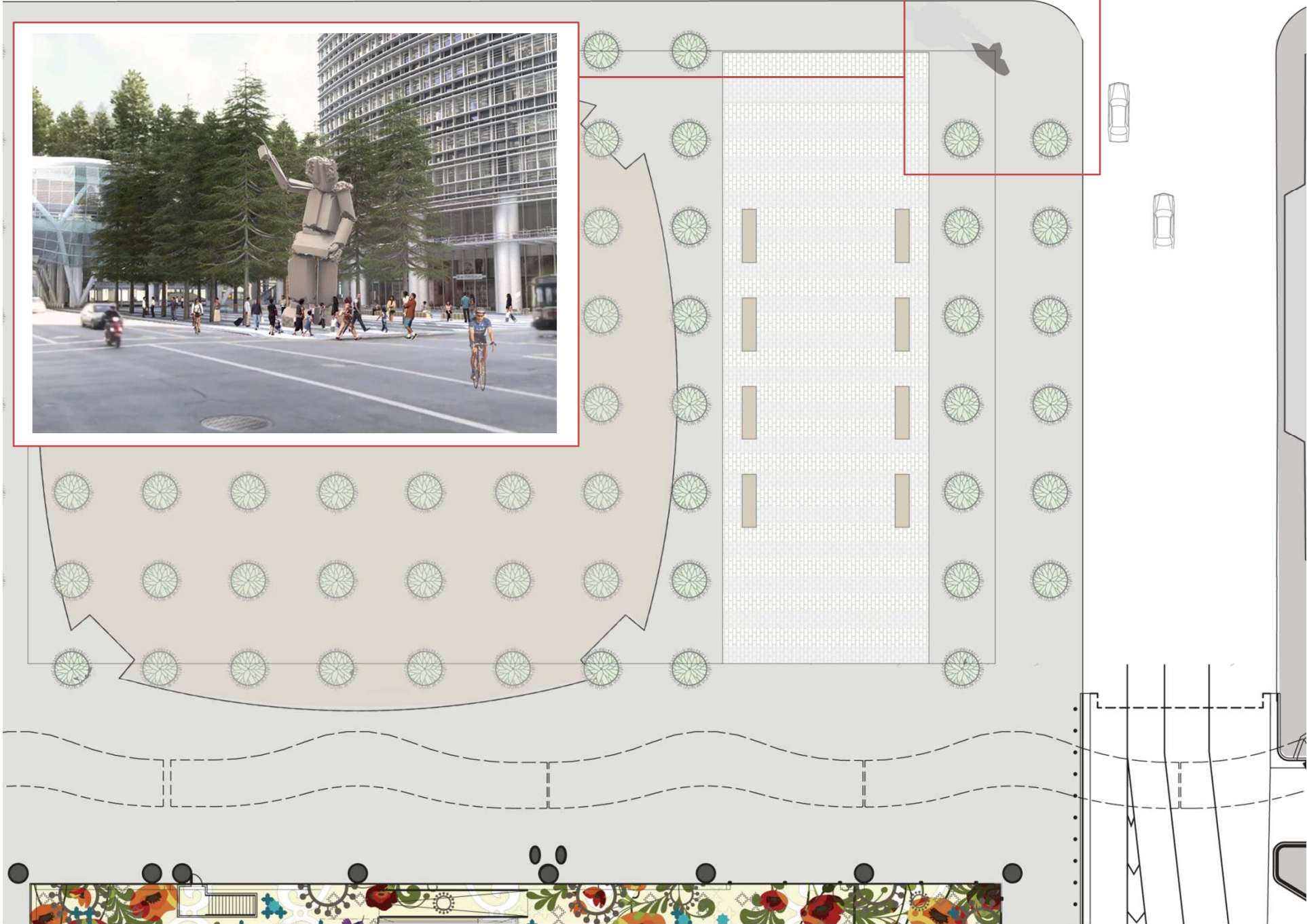





Luxor – Two Ramses



Sravanbelagola - India





Borobudur – Java Indonesia



Pallas Athena – Austrian State Parliament Building



Male / Female – Jonathan Borofsky Pennsylvania Station Baltimore, Maryland



*Maman, Louise Bourgeois, Tate Modern, London*



*Three Heads Six Arms, Zhang Huan , San Francisco City Hall*